

PLATING CONTACT AREA:

DASH NR:	PERFORMANCE LEVEL
-1YY/1YYLF	TELCORDIA CO
-2YY/2YYLF	CUSTOMER SPECIAL
-3YY/3YYLF	CUSTOMER SPECIAL

PRODUCT NR.	DIM "A"
88956-X01	5.00 REF.
88956-X11	3.35 REF.
88956-X20	5.76 REF.
88956-X01LF	5.00 REF.
88956-X11LF	3.35 REF.
88956-X20LF	5.76 REF.

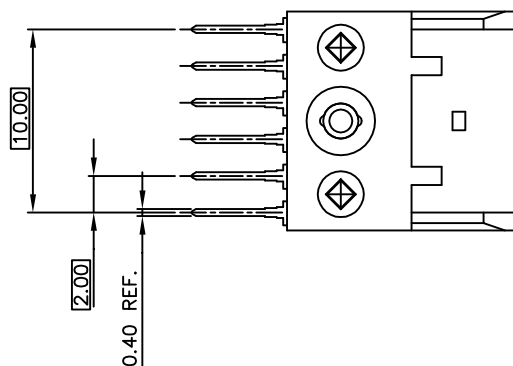
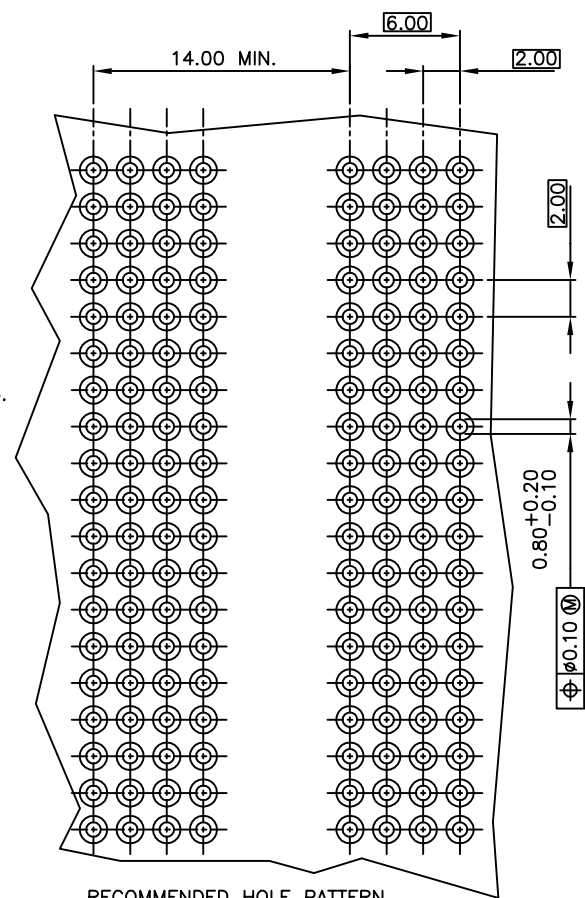
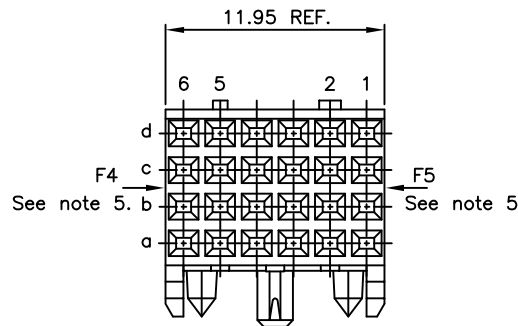
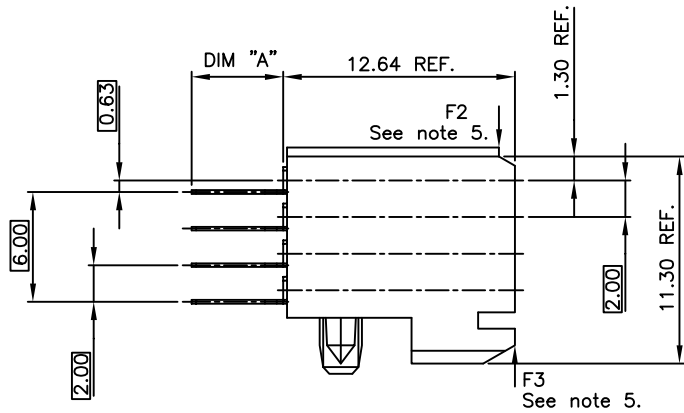

NOTES:

1. BODY MAT'L: LIQUID CRYSTAL POLYMER 30% GLASS
FLAME RETARDANT ACC. UL 94-V0
2. TERMINAL MATERIAL: PHOSPHOR BRONZE.
3. PLATING SOLDER TAILS 2-8 μm SnPb 90-97 OR PURE Sn FOR LF.
4. LOAD IN THIS DIRECTION (E.G. THROUGH CODING) 30 NEWTON MAXIMUM PER CONNECTOR.
5. LOAD IN THIS DIRECTION 15 NEWTON MAXIMUM PER CONNECTOR.
6. TO ENSURE PROPER ALIGNMENT OF MULTIPLE MODULES ON A BOARD THE USE OF A FIXTURE IS RECOMMENDED.
7. PRODUCT MARKING: PARTNUMBER & BATCH I.D.
8. THIS PRODUCT MEETS EUROPEAN UNION DIRECTIVES AND OTHER COUNTRY REGULATIONS AS DESCRIBED IN GS-22-008 .
9. THE HOUSING WILL WITHSTAND EXPOSURE TO 260DEGREE PEAK TEMPERATURE FOR 10 SECONDS IN A WAVE SOLDER APPLICATION.

mat'l. code		tolerances unless otherwise specified		CUSTOMER COPY			
ltr	ecr no	dr	date	projection		title	
H	D007-0170	Cent	05/22/07	Linear		STR FEMALE STB	
J	D008-0171	TER	8/26/08			SIGNAL 12MM	
K	D009-0088	Cent	06/06/08	mm		product family METRAL (tm)	
-	-	dr	R Rijken	910423	size		dwg no
E	H40355	DOB	940527	engr	H.Bouwknegt	931119	213
F	H90430	DOB	990722	chr	A van Zanten	910423	sheet
G	0005-048	CLU	051115	app	van Woensel	911210	1 of 1
sheet	revision						
index	sheet						