

PART NUMBER	REV	FIRST USED
567917-1	E	854040-3

TERMINAL NAME: CRIMP TERMINAL, MILLI-GRID, 2mm		VISIBLE PAD LTR	CRIMP HEIGHT	WIRE SIZE	
		A	.025 ±.002 [0.64 ±0.05mm]	24	
		B	.024 ±.002 [0.61 ±0.05mm]	26	
		C	.023 ±.002 [0.58 ±0.05mm]	28	
		D	.022 ±.002 [0.56 ±0.05mm]	30	
TYCO P/N	MFG P/N	CRIMP	SIZE	TYPE	RANGE
1642396-1	50394-8051	WIRE	.039 [0.99mm]	F	30-24
1642397-1	50212-8000	INSUL	.055 [1.40mm]	F	.031 - .055
994698-1	50394-8052				
994698-2	50394-8051				
621528-1	50394-8051				
WIRE STRIP LENGTH	TERM APPL SPEC	FEED	APPL INSTRUCTION	SET UP GAGE	LAYOUT
.051 - .071	NONE	.270	SEE CUSTOMER MANUAL	NONE	L1716

SIM TO HDM 1385641

THIS DRAWING IS A CONTROLLED DOCUMENT.

THIS DRAWING IS UNPUBLISHED. RELEASED FOR PUBLICATION BY AMP INCORPORATED. ALL RIGHTS RESERVED.

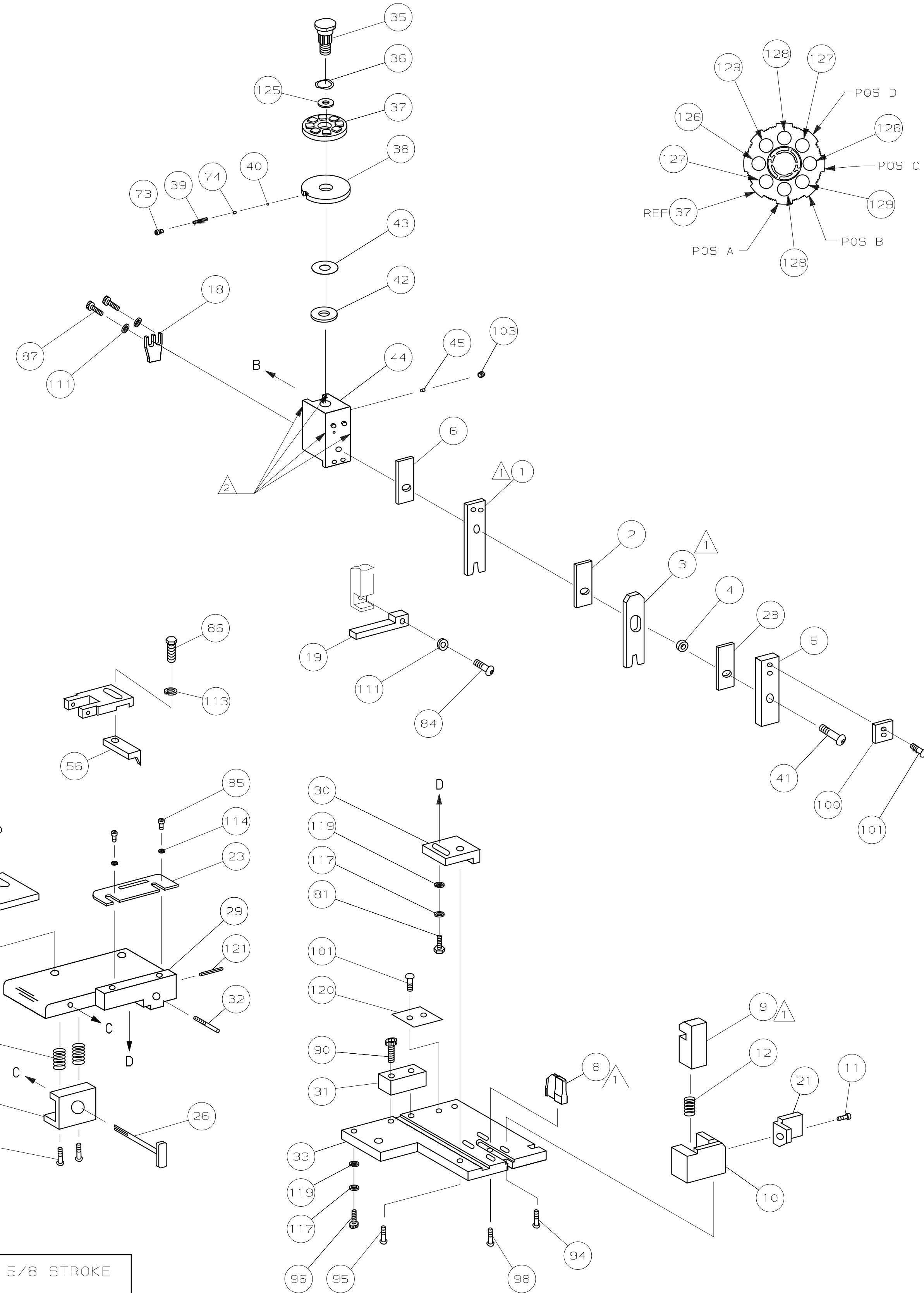

- 1 RECOMMENDED SPARE PARTS.
- 2 GREASE LIGHTLY.
- 3 ITEM NOT SHOWN
- 4 GUIDE OFF INSULATION BARREL.

QTY	REV	TER	APPL	SPEC	FEED	APPL INSTRUCTION	SET UP GAGE	LAYOUT	DESCRIPTION	ITEM NO
2	-	C			6-354779-4	PIN, WIRE DISC (.3310)B			129	129
2	-	C			6-354779-2	PIN, WIRE DISC (.3300)A			128	128
2	-	C			6-354779-0	PIN, WIRE DISC (.3290)D			127	127
2	-	C			5-354779-8	PIN, WIRE DISC (.3280)C			126	126
1	-	A			986950-1	WASHER, FLAT PRECISION			125	125
1	-	A			217238-3	DOCUMENTATION PACKAGE			124	124
									123	123
									122	122
1	-	A			4-21028-0	PIN, SLT SPR (Ø.093x.75) ST GDE PL			121	121
1	-	B			690701-2	PLATE, SERIAL NO.			120	120
2	-	A			21899-2	WASHER, FLAT (#10) S G ADJ BLK			119	119
									118	118
2	-	A			21024-5	WASHER, LOCK (#10) ADJ BLOCK			117	117
									116	116
									115	115
2	-	A			21024-2	WASHER, LOCK (#4) FRONT STP GUIDE			114	114
REF	-	A			21024-4	WASHER, LOCK (#8) FEED FINGER			113	113
									112	112
2	-	A			21024-4	WASHER, LOCK (#8) STRIPPER			111	111
									110	110
									109	109
									108	108
									107	107
									106	106
									105	105
									104	104
1	-	A			21009-2	SCR, SKT SET (1/4-20x.25 LW) RAM			103	103
									102	102
4	-	A			21017-2	SCR, DRIVE (#2x.19) ID PLATE			101	101
1	-	B			819347-1	PLATE, IDENTIFICATION			100	100
2	-	A			3-21002-0	SCR, BHC (10-32x.88) DRAG			99	99
1	-	A			22733-8	SCR, BHC (8-32x.38 LW) ANVIL			98	98
									97	97
1	-	A			3-21000-8	SCR, SHC (10-32x.88) MOUNTING			96	96
1	-	A			2-21002-7	SCR, BHC (10-32x.50) SG ADJ BLK			95	95
4	-	A			2-21002-2	SCR, BHC (8-32x.50) SHEAR-TERM SUP			94	94
									93	93
									92	92
1	-	A			1-21002-7	SCR, SHC (6-32x.50) CAM			91	91
2	-	A			2-21000-7	SCR, SHC (8-32x.50) SCR BLK			90	90
									89	89
									88	88
2	-	A			2-21000-5	SCR, SHC (8-32x.38) HOLDER			87	87
REF	-	A			2-22603-0	SCR, HEX HD (8-32x.31) FEED FINGER			86	86
2	-	A			1-21000-3	SCR, SHC (4-40x.25) F ST GUIDE			85	85
REF	-	A			22733-9	SCR, BHC (8-32x.50 SL) STRIPPER			84	84
									83	83
									82	82
1	-	A			3-22603-1	SCR, HEX (10-32x.38) SG ADJ BL			81	81
									80	80
									79	79
									78	78
2	-	B			463310-9	BLADE, STRIPPING (#28)			77	77
									76	76
									75	75
1	-	A			690603-1	SPRING, ASSIST			74	74
1	-	A			23030-1	SCR, SKT CAP (6-32x.25) CP DSC			73	73
									72	72
									71	71

QTY	REV	TER	APPL	SPEC	FEED	APPL INSTRUCTION	SET UP GAGE	LAYOUT	DESCRIPTION	ITEM NO
-1	U/M									

QTY	REV	TER	APPL	SPEC	FEED	APPL INSTRUCTION	SET UP GAGE	LAYOUT	DESCRIPTION	ITEM NO
										70
										69
										68
										67
										66
										65
										64
										63
										62
										61
										60
										59
										58
										57
REF	-	B			694433-8	PAWL, FEED				56
										55
										54
										53
										52
										51
										50
										49
1	-	A			690602-6	CAM, PRE-FEED 1.62 STROKE				48
										47
										46
1	-	A			690191-1	PLUG, NYLON				45
1	-	C			455673-3	RAM				44
1	-	A			690125-1	WASHER, LAMINATED				43
1	-	A			690124-1	WASHER, RAM				42
1	-	A			7-21002-9	BOLT, CRIMPER (5/16x1.00)				41
1	-	A			23241-6	BALL, STEEL				40
1	-	A			690170-1	SPRING, COMPRESSION				39
1	-	C			690142-1	DISC, INSULATION				38
1	-	D			354777-1	WIRE DISC, PLASTIC				37
1	-	A			22480-5	WASHER, SPRING				36
1	-	B			690212-1	POST, RAM				35
										34
1	-	C			462544-1	PLATE, BASE SPECIAL				33
1	-	A			690432-3	SCREW, ADJUSTMENT				32
1	-	B			462543-1	BLOCK, SCREW SPECIAL				31
1	-	B			455689-1	BLOCK, STRIP GUIDE ADJ				30
1	-	C			455671-1	PLATE, STRIP GUIDE				29
1	-	C			1-455888-0	SPACER, FRONT SHEAR DEP				28
2	-	A			1-22284-0	SPRING, DRAG				27
1	-	B			690546-1	LEVER, DRAG RELEASE				26
1	-	B			240792-1	DRAG, TERMINAL				25
1	-	D			6-690504-4	GUIDE, STRIP (REAR)				24
1	-	A			690438-1	GUIDE, STRIP (FRONT)				23
										22
1	-	A			463756-1	GUIDE, SCRAP				21
										20
1	-	C			462615-4	STRIPPER				19
1	-	C			2-690518-4	HOLDER, TERMINAL				18
										17
										16
										15
										14
										13
1	-	A			3-22280-3	SPRING, SHEAR				12
1	-	B			690461-1	STOP, SHEAR (FRONT)				11
1	-	B			690459-1	HOLDER, SHEAR (FRONT) SP				10
1	-	B			462006-1	SHEAR, FLOAT (FRONT) SP				9
1	-	C			9-805887-4	ANVIL				8
										7
1	-	C			455888-3	SPACER, CRIMPER				6
1	-	A			462838-1	DEPRESSOR, SHEAR (FRONT) SP				5
1	-	B			2-238011-3	SPACER, BLOCK CRIMPER				4
1	-	C			5-683453-2	CRIMPER, INSULATION				3
1	-	C			455888-1	SPACER, CRIMPER				2
1	-	C			5-1490019-0	CRIMPER, WIRE				1

QTY	REV	TER	APPL	SPEC	FEED	APPL INSTRUCTION	SET UP GAGE	LAYOUT	DESCRIPTION	ITEM NO
-1	U/M									

LOC A
DIST 66

567917

D

C

B

A