

| PART NUMBER | REV | FIRST USED | POWER UNIT | FEED TYPE | DESCRIPTION |
|-------------|-----|------------|---------------|-----------|--------------------|
| 1852862-1 | B | 122500-1 | LEADMAKER | AIR FEED | CUTS CARRIER |
| 1852862-2 | B | 565435-5 | BENCH MODEL K | AIR FEED | CUTS CARRIER |
| 1852862-3 | B | 354500-1 | BENCH MODEL G | AIR FEED | CUTS CARRIER |
| 1852862-6 | B | 122500-1 | LEADMAKER | AIR FEED | CONTINUOUS CARRIER |
| 7-1852862-7 | A | - | - | - | SPARE PARTS |

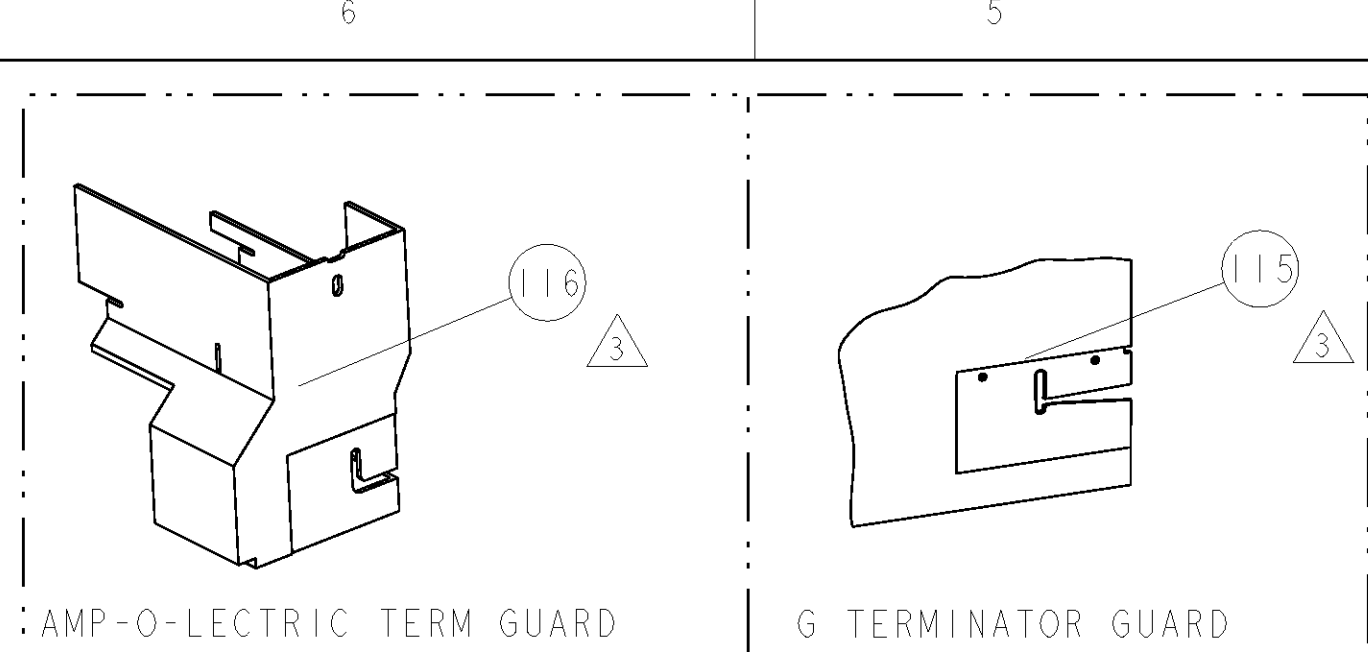

| TE PN | | TE TERMINAL - TE CRIMP SPECS | | |
|-------------------|----------------|------------------------------|---|-------------|
| 963774 | - | CRIMP HEIGHT | | |
| - | - | WIRE SIZE | | |
| - | - | PAD LTR | CRIMP HEIGHT | |
| - | - | A | 3.60mm+ .05/- .05 [.142+ .002/- .002] | |
| - | - | B | 3.29mm+ .05/- .05 [.130+ .002/- .002] | |
| - | - | C | 2.98mm+ .05/- .05 [.117+ .002/- .002] | |
| - | - | D | - | |
| SEAL PN | WIRE | SIZE | TYPE | RANGE |
| 1355437-1 | - | 5.08mm [.200] | F | 6-10mm2 |
| 1355437-2 | - | 10.95mm [.430] | O | ∅10.000 MAX |
| WIRE STRIP LENGTH | TERM APPL SPEC | FEED | APPLICATOR INSTRUCTIONS | SET UP GAGE |
| 9.70-10.30 | 114-18076 | 32.50 | 408-8040 | 458637-1 |

| LOC | DIST | REV | DATE | BY | APPD |
|-----|------|-----|-----------|----|------|
| A | 66 | B | 17MAR2010 | RB | GB |

- △ RECOMMENDED SPARE PARTS
- △ GREASE LIGHTLY
- △ GUARD MUST BE IN PLACE WHEN OPERATING APPLICATOR IN A BENCH MACHINE
- △ APPLY TORQ-SEAL IN ALLEN SOCKET TO FILL HOLE AFTER FLAT HD HAS BEEN ADJUSTED TO CORRECT HEIGHT AT QUALIFICATION. APPLY PN 1-23419-5 LOC-TITE TO THREADS.
- △ THE INSULATION RANGE LISTED IS FOR THE TERMINAL. THE INSULATION RANGE FOR THE SEALS ARE LISTED BELOW.

| SEAL PN | INSULATION RANGE |
|-----------|------------------|
| 1355437-1 | ∅4.6-5.2mm |
| 1355437-2 | ∅5.8-6.6mm |

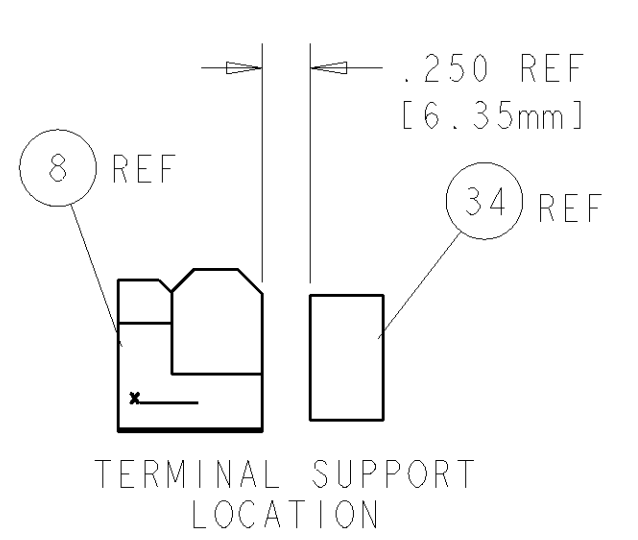
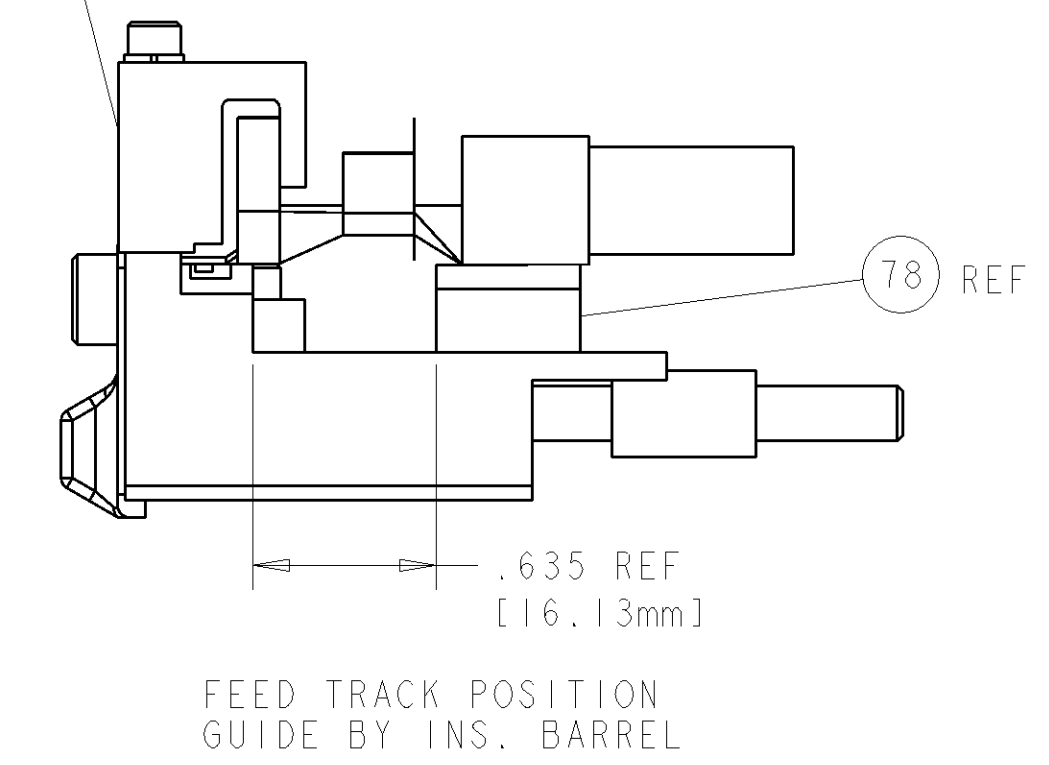
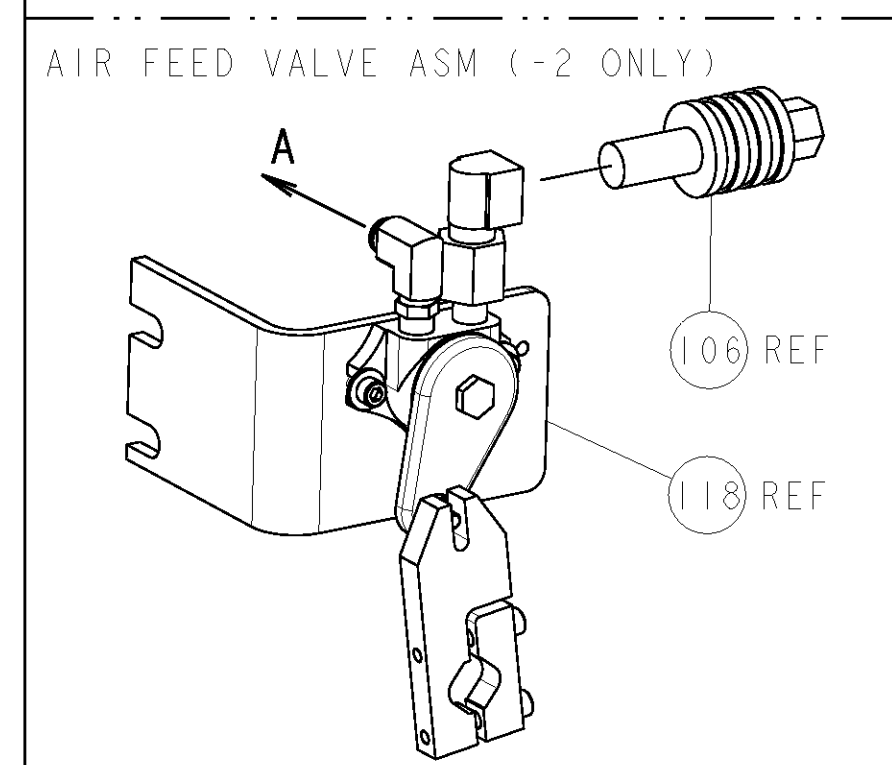
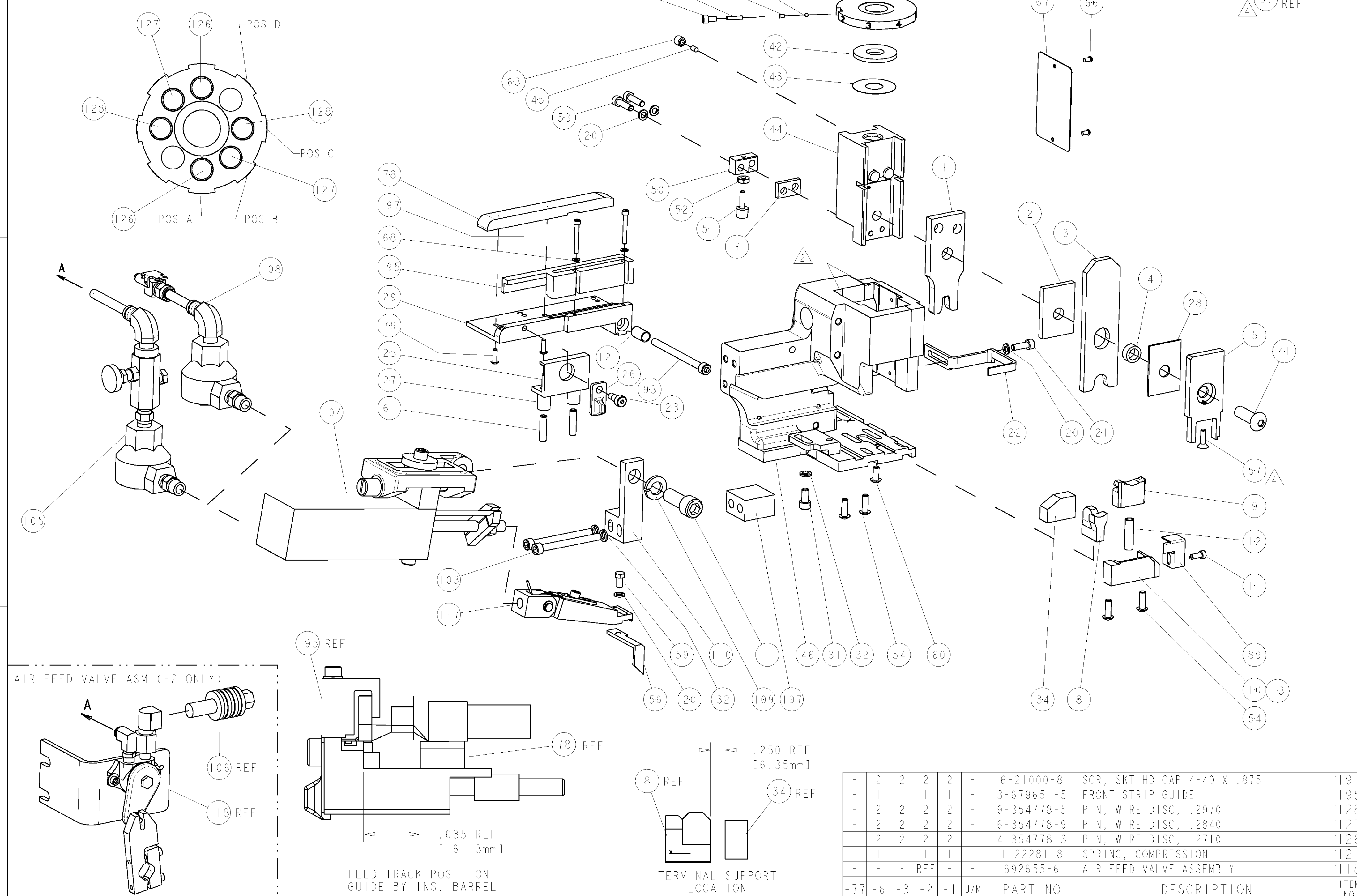

| QTY | PART NO | DESCRIPTION | ITEM NO | | | | | |
|-----|------------|-----------------------------|-------------------------|-----|-----|---------|-------------|---------|
| - 2 | 6-21000-8 | SCR, SKT HD CAP 4-40 X .875 | 197 | | | | | |
| - 1 | 3-679651-5 | FRONT STRIP GUIDE | 195 | | | | | |
| - 2 | 9-354778-5 | PIN, WIRE DISC, .2970 | 128 | | | | | |
| - 2 | 6-354778-9 | PIN, WIRE DISC, .2840 | 127 | | | | | |
| - 2 | 4-354778-3 | PIN, WIRE DISC, .2710 | 126 | | | | | |
| - 1 | 1-22281-8 | SPRING, COMPRESSION | 121 | | | | | |
| - | REF | 692655-6 | AIR FEED VALVE ASSEMBLY | 118 | | | | |
| -77 | -6 | -3 | -2 | -1 | U/M | PART NO | DESCRIPTION | ITEM NO |

| QTY | PART NO | DESCRIPTION | ITEM NO |
|-----|-------------|--------------------------------------|---------|
| - | 461062-1 | FEED FINGER ASSEMBLY | 117 |
| - | 455749-1 | GUARD WINDOW | 116 |
| - | 679532-1 | INSERT, GUARD | 115 |
| - | 690603-1 | SPRING ASSIST AMP-O-MATOR APPLICATOR | 112 |
| - | 3-21001-5 | SCR, SKT HD CAP 3/8-16 X 1.000 | 111 |
| - | 459610-3 | MOUNT, FEED BRACKET | 110 |
| - | 21024-8 | WASHER, SPRG LOCK, REG 3/8 | 109 |
| - | 692655-7 | AIR FEED VALVE ASSEMBLY | 108 |
| - | 461690-1 | SPACER, AIR FEED | 107 |
| - | 24024-2 | VALVE, SHUT OFF | 106 |
| - | 692655-5 | AIR FEED VALVE ASSEMBLY | 105 |
| - | 461065-2 | ASSEMBLY, AIR FEED | 104 |
| - 2 | 4-21000-3 | SCR, SKT HD CAP 10-32 X 2.000 | 103 |
| - | 8-21000-7 | SCR, SKT HD CAP 10-32 X 2.500 | 93 |
| - | 318563-1 | GUARD, FRONT CHIP | 89 |
| - 2 | 1-21002-4 | SCR, BTN SKT HD CAP 4-40 X .375 | 79 |
| - | 1633580-4 | FENCE | 78 |
| - | 4088040 | SF APPL INST 408-8040 | 72 |
| - | 217238-1 | GENERAL INSTRUCTION PKG | 71 |
| - 2 | 21024-2 | WASHER, SPRG LOCK, REG NO 4 | 68 |
| - | 461264-1 | PLATE, IDENTIFICATION | 67 |
| - 2 | 21017-2 | SCREW, DRIVE | 66 |
| - | 986950-1 | WASHER, FLAT PRECISION | 64 |
| - | 21009-2 | SCR, SET, SELF LOCKING 1/4-20 X .250 | 63 |
| - | 23030-1 | SCR, SKT HD CAP 6-32 X .25 | 62 |
| - 2 | 5-21006-6 | SCR, SET, CUP POINT 10-32 X .750 | 61 |
| - | 22733-8 | SCR, BHSC, SELF-LOCKING, 8-32 X .375 | 60 |
| - | 2-22603-0 | SCREW, MACH, HEX HD, 8-32 X .312 | 59 |
| - | 2-21003-0 | SCR, FLT SKT HD CAP 6-32 X .500 | 57 |
| - | 5-694433-2 | FEED PAWL | 56 |
| - 4 | 2-21002-2 | SCR, BTN SKT HD CAP 8-32 X .500 | 54 |
| - 2 | 2-21000-8 | SCR, SKT HD CAP 8-32 X .625 | 53 |
| - | 21018-5 | NUT, HEX, REG 6-32 | 52 |
| - | 811242-8 | BUMPER, HOLD DOWN | 51 |
| - | 690753-1 | SPACER, TONKER | 50 |
| - | 1-1633399-6 | APPL. BASIC AIR FEED SUB ASSY | 46 |
| - | 690191-1 | PLUG, NYLON | 45 |
| - | 1-819307-0 | RAM, SIDE FEED | 44 |
| - | 690125-1 | SHIM SUB-ASSY | 43 |
| - | 1-690124-3 | WASHER, RAM (.105) | 42 |
| - | 7-21002-9 | SCR, BTN SKT HD CAP 5/16-24 X 1.00 | 41 |
| - | 23241-6 | BALL, STEEL | 40 |
| - | 690170-1 | SPRING, COMPRESSION | 39 |
| - | 1-690142-1 | DISC, INSULATION | 38 |
| - | 354777-1 | WIRE DISC, ASSEMBLY | 37 |
| - | 22480-5 | SPRING, COMPRESSION | 36 |
| - | 690212-1 | POST, RAM | 35 |
| - | 690786-7 | TERMINAL SUPPORT | 34 |
| - 3 | 21024-5 | WASHER, SPRG LOCK, REG NO 10 | 32 |
| - | 3-21000-4 | SCR, SKT HD CAP 10-32 X .375 | 31 |
| - | 1-1633087-0 | PLATE, STRIP GUIDE | 29 |
| - | 1-455888-0 | SPACER, CRIMPER | 28 |
| - 2 | 1-22282-1 | SPRING, COMPRESSION | 27 |
| - | 356835-1 | LEVER, DRAG RELEASE | 26 |
| - | 240792-1 | DRAG, TERMINAL | 25 |
| - | 21989-8 | SCR, SKT HD SHLDR 3/16 DIA X .250 | 23 |
| - | 1-456468-3 | STRIPPER, SPECIAL | 22 |
| - | 2-21000-7 | SCR, SKT HD CAP 8-32 X .500 | 21 |
| - 4 | 21024-4 | WASHER, SPRG LOCK, REG NO 8 | 20 |
| - | 1-679625-8 | SHEAR HOLDER, FRONT (NO CUT) | 13 |
| - | 4-22280-8 | SPRING, COMPRESSION | 12 |
| - | 1-690461-7 | STOP, SHEAR | 11 |
| - | 1-690459-7 | SHEAR HOLDER, FRONT | 10 |
| - | 318059-1 | FLOATING SHEAR, FRONT | 9 |
| - | 3-1633332-3 | ANVIL, COMBINATION | 8 |
| - | 240641-5 | SPACER | 7 |
| - | - | - | 6 |
| - | 122399-2 | DEPRESSOR, SHEAR | 5 |
| - | 1-238011-4 | BLOCK, CRIMPER SPACER | 4 |
| - | 1-655830-8 | CRIMPER, INSUL O | 3 |
| - | 2-455888-8 | SPACER, CRIMPER | 2 |
| - | 5-657555-1 | CRIMPER, WIRE PREMIUM | 1 |

| | | | | | | | | | | | | | |
|--------------------|---|--|---|----------------|---|----------------|---|-----------------|---|-----------------|---|--------------------------------|---|
| DIMENSIONS: INCHES | | TOLERANCES UNLESS OTHERWISE SPECIFIED: | | DWN: T2AUG2009 | | CHK: G. BALLEW | | APVD: M. DEMING | | DATE: 12AUG2009 | | NAME: SIDE FEED HDM APPLICATOR | |
| 9 PLC | ± | 10 PLC | ± | 11 PLC | ± | 12 PLC | ± | 13 PLC | ± | 14 PLC | ± | 15 PLC | ± |
| 16 PLC | ± | 17 PLC | ± | 18 PLC | ± | 19 PLC | ± | 20 PLC | ± | 21 PLC | ± | 22 PLC | ± |
| 23 PLC | ± | 24 PLC | ± | 25 PLC | ± | 26 PLC | ± | 27 PLC | ± | 28 PLC | ± | 29 PLC | ± |
| 30 PLC | ± | 31 PLC | ± | 32 PLC | ± | 33 PLC | ± | 34 PLC | ± | 35 PLC | ± | 36 PLC | ± |
| 37 PLC | ± | 38 PLC | ± | 39 PLC | ± | 40 PLC | ± | 41 PLC | ± | 42 PLC | ± | 43 PLC | ± |
| 44 PLC | ± | 45 PLC | ± | 46 PLC | ± | 47 PLC | ± | 48 PLC | ± | 49 PLC | ± | 50 PLC | ± |
| 51 PLC | ± | 52 PLC | ± | 53 PLC | ± | 54 PLC | ± | 55 PLC | ± | 56 PLC | ± | 57 PLC | ± |
| 58 PLC | ± | 59 PLC | ± | 60 PLC | ± | 61 PLC | ± | 62 PLC | ± | 63 PLC | ± | 64 PLC | ± |
| 65 PLC | ± | 66 PLC | ± | 67 PLC | ± | 68 PLC | ± | 69 PLC | ± | 70 PLC | ± | 71 PLC | ± |
| 72 PLC | ± | 73 PLC | ± | 74 PLC | ± | 75 PLC | ± | 76 PLC | ± | 77 PLC | ± | 78 PLC | ± |
| 79 PLC | ± | 80 PLC | ± | 81 PLC | ± | 82 PLC | ± | 83 PLC | ± | 84 PLC | ± | 85 PLC | ± |
| 86 PLC | ± | 87 PLC | ± | 88 PLC | ± | 89 PLC | ± | 90 PLC | ± | 91 PLC | ± | 92 PLC | ± |
| 93 PLC | ± | 94 PLC | ± | 95 PLC | ± | 96 PLC | ± | 97 PLC | ± | 98 PLC | ± | 99 PLC | ± |
| 100 PLC | ± | 101 PLC | ± | 102 PLC | ± | 103 PLC | ± | 104 PLC | ± | 105 PLC | ± | 106 PLC | ± |
| 107 PLC | ± | 108 PLC | ± | 109 PLC | ± | 110 PLC | ± | 111 PLC | ± | 112 PLC | ± | 113 PLC | ± |
| 114 PLC | ± | 115 PLC | ± | 116 PLC | ± | 117 PLC | ± | 118 PLC | ± | 119 PLC | ± | 120 PLC | ± |
| 121 PLC | ± | 122 PLC | ± | 123 PLC | ± | 124 PLC | ± | 125 PLC | ± | 126 PLC | ± | 127 PLC | ± |
| 128 PLC | ± | 129 PLC | ± | 130 PLC | ± | 131 PLC | ± | 132 PLC | ± | 133 PLC | ± | 134 PLC | ± |
| 135 PLC | ± | 136 PLC | ± | 137 PLC | ± | 138 PLC | ± | 139 PLC | ± | 140 PLC | ± | 141 PLC | ± |
| 142 PLC | ± | 143 PLC | ± | 144 PLC | ± | 145 PLC | ± | 146 PLC | ± | 147 PLC | ± | 148 PLC | ± |
| 149 PLC | ± | 150 PLC | ± | 151 PLC | ± | 152 PLC | ± | 153 PLC | ± | 154 PLC | ± | 155 PLC | ± |
| 156 PLC | ± | 157 PLC | ± | 158 PLC | ± | 159 PLC | ± | 160 PLC | ± | 161 PLC | ± | 162 PLC | ± |
| 163 PLC | ± | 164 PLC | ± | 165 PLC | ± | 166 PLC | ± | 167 PLC | ± | 168 PLC | ± | 169 PLC | ± |
| 170 PLC | ± | 171 PLC | ± | 172 PLC | ± | 173 PLC | ± | 174 PLC | ± | 175 PLC | ± | 176 PLC | ± |
| 177 PLC | ± | 178 PLC | ± | 179 PLC | ± | 180 PLC | ± | 181 PLC | ± | 182 PLC | ± | 183 PLC | ± |
| 184 PLC | ± | 185 PLC | ± | 186 PLC | ± | 187 PLC | ± | 188 PLC | ± | 189 PLC | ± | 190 PLC | ± |
| 191 PLC | ± | 192 PLC | ± | 193 PLC | ± | 194 PLC | ± | 195 PLC | ± | 196 PLC | ± | 197 PLC | ± |
| 198 PLC | ± | 199 PLC | ± | 200 PLC | ± | 201 PLC | ± | 202 PLC | ± | 203 PLC | ± | 204 PLC | ± |
| 205 PLC | ± | 206 PLC | ± | 207 PLC | ± | 208 PLC | ± | 209 PLC | ± | 210 PLC | ± | 211 PLC | ± |
| 212 PLC | ± | 213 PLC | ± | 214 PLC | ± | 215 PLC | ± | 216 PLC | ± | 217 PLC | ± | 218 PLC | ± |
| 219 PLC | ± | 220 PLC | ± | 221 PLC | ± | 222 PLC | ± | 223 PLC | ± | 224 PLC | ± | 225 PLC | ± |
| 226 PLC | ± | 227 PLC | ± | 228 PLC | ± | 229 PLC | ± | 230 PLC | ± | 231 PLC | ± | 232 PLC | ± |
| 233 PLC | ± | 234 PLC | ± | 235 PLC | ± | 236 PLC | ± | 237 PLC | ± | 238 PLC | ± | 239 PLC | ± |
| 240 PLC | ± | 241 PLC | ± | 242 PLC | ± | 243 PLC | ± | 244 PLC | ± | 245 PLC | ± | 246 PLC | ± |
| 247 PLC | ± | 248 PLC | ± | 249 PLC | ± | 250 PLC | ± | 251 PLC | ± | 252 PLC | ± | 253 PLC | ± |
| 254 PLC | ± | 255 PLC | ± | 256 PLC | ± | 257 PLC | ± | 258 PLC | ± | 259 PLC | ± | 260 PLC | ± |
| 261 PLC | ± | 262 PLC | ± | 263 PLC | ± | 264 PLC | ± | 265 PLC | ± | 266 PLC | ± | 267 PLC | ± |
| 268 PLC | ± | 269 PLC | ± | 270 PLC | ± | 271 PLC | ± | 272 PLC | ± | 273 PLC | ± | 274 PLC | ± |
| 275 PLC | ± | 276 PLC | ± | 277 PLC | ± | 278 PLC | ± | 279 PLC | ± | 280 PLC | ± | 281 PLC | ± |
| 282 PLC | ± | 283 PLC | ± | 284 PLC | ± | 285 PLC | ± | 286 PLC | ± | 287 PLC | ± | 288 PLC | ± |
| 289 PLC | ± | 290 PLC | ± | 291 PLC | ± | 292 PLC | ± | 293 PLC | ± | 294 PLC | ± | 295 PLC | ± |
| 296 PLC | ± | 297 PLC | ± | 298 PLC | ± | 299 PLC | ± | 300 PLC | ± | 301 PLC | ± | 302 PLC | ± |
| 303 PLC | ± | 304 PLC | ± | 305 PLC | ± | 306 PLC | ± | 307 PLC | ± | 308 PLC | ± | 309 PLC | ± |
| 310 PLC | ± | 311 PLC | ± | 312 PLC | ± | 313 PLC | ± | 314 PLC | ± | 315 PLC | ± | 316 PLC | ± |
| 317 PLC | ± | 318 PLC | ± | 319 PLC | ± | 320 PLC | ± | 321 PLC | ± | 322 PLC | ± | 323 PLC | ± |
| 324 PLC | ± | 325 PLC | ± | 326 PLC | ± | 327 PLC | ± | 328 PLC | ± | 329 PLC | ± | 330 PLC | ± |
| 331 PLC | ± | 332 PLC | ± | 333 PLC | ± | 334 PLC | ± | 335 PLC | ± | 336 PLC | ± | 337 PLC | ± |
| 338 PLC | ± | 339 PLC | ± | 340 PLC | ± | 341 PLC | ± | 342 PLC | ± | | | | |