

Customer Information Sheet

DRAWING No.: P13-XX23

SHEET 2 OF 2

IF IN DOUBT - ASK

©

NOT TO SCALE

THIRD ANGLE PROJECTION

ALL DIMENSIONS IN mm

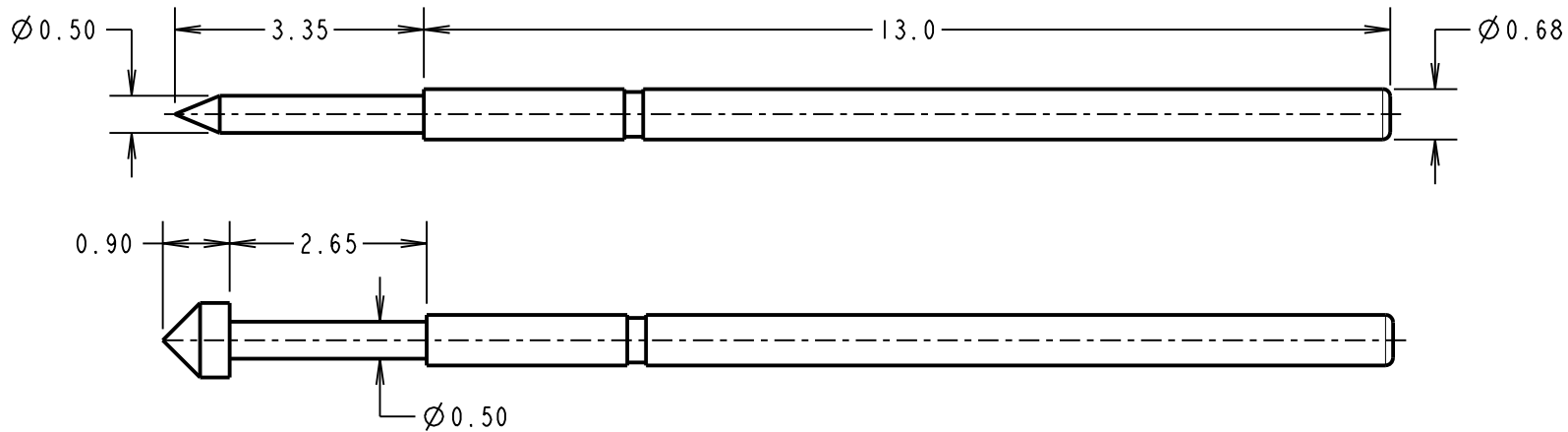

ORDER CODE
P13-XX23
PROBE HEAD
VARIANT (SEE TABLE)

NOTES:

1. TO BE USED WITH SLEEVE S13-503.
2. SUITABLE FOR A MINIMUM DISTANCE BETWEEN CENTRES OF 1.27mm.

PROBE HEAD VARIANTS

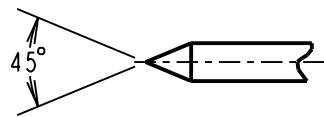

SPEAR HEAD
P13-0123

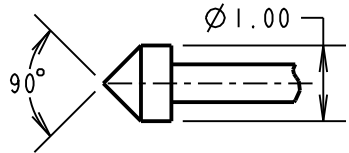

CONVEX HEAD
P13-2123

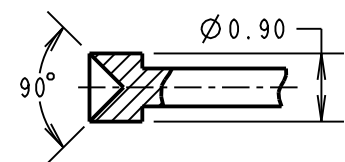

CONCAVE HEAD
P13-1123

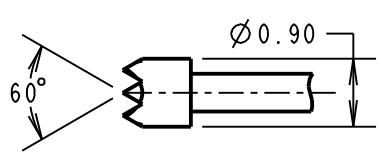

SERRATED HEAD
P13-4023

SPECIFICATIONS:

MATERIAL:

PLUNGER = BERYLLIUM COPPER
BARREL = PHOSPHOR BRONZE
SPRING = MUSIC WIRE

FINISH:

PLUNGER, BARREL AND SPRING = GOLD

ELECTRICAL:

CURRENT RATING = 3A
CONTACT RESISTANCE = 30m Ω

MECHANICAL:

DURABILITY = 1,000,000 CYCLES
FULL TRAVEL = 2.65mm
SPRING FORCES:

AT FULL TRAVEL = 1.18N \pm 0.24N (120G \pm 20%)
AT 2/3 TRAVEL = 0.88N \pm 0.18N (90g \pm 20%)

ENVIRONMENTAL:

OPERATING TEMPERATURE = -40°C TO +85°C

SB	6	07.10.14	12618
NAME	ISS.	DATE	C/NOTE
APPROVED: S.BENNETT			
CHECKED: M.PLESTED			
DRAWN: W.J.BOURNE			
CUSTOMER REF.:			
ASSEMBLY DRG:			

HARWIN

www.harwin.com
technical@harwin.com

THIS DRAWING AND ANY INFORMATION OR DESCRIPTIVE MATTER SET OUT HEREON ARE CONFIDENTIAL AND COPYRIGHT PROPERTY OF THE HARWIN GROUP AND MUST NOT BE DISCLOSED, LOANED, COPIED OR USED FOR MANUFACTURING, TENDERING OR FOR ANY OTHER PURPOSE WITHOUT THEIR WRITTEN PERMISSION.

TOLERANCES

X. = ± 1 mm
X.X = ± 0.25 mm
X.XX = ± 0.10 mm
X.XXX = ± 0.01 mm

ANGLES = $\pm 5^\circ$

UNLESS STATED

MATERIAL:

SEE ABOVE

FINISH: SEE ABOVE

S/AREA: mm²

TITLE:

1.27mm MIN. CENTRE
TWO-PIECE SPRING PROBE

DRAWING NUMBER:

P13-XX23

SHT
2 OF 2