

THIS DRAWING IS A CONTROLLED DOCUMENT.

THIS DRAWING IS UNCLASSIFIED DATE 11/18/01 BY 49P INCORPORATED. ALL RIGHTS RESERVED. © COPYRIGHT 1998

DIST 66

* Trademark of AMP Incorporated

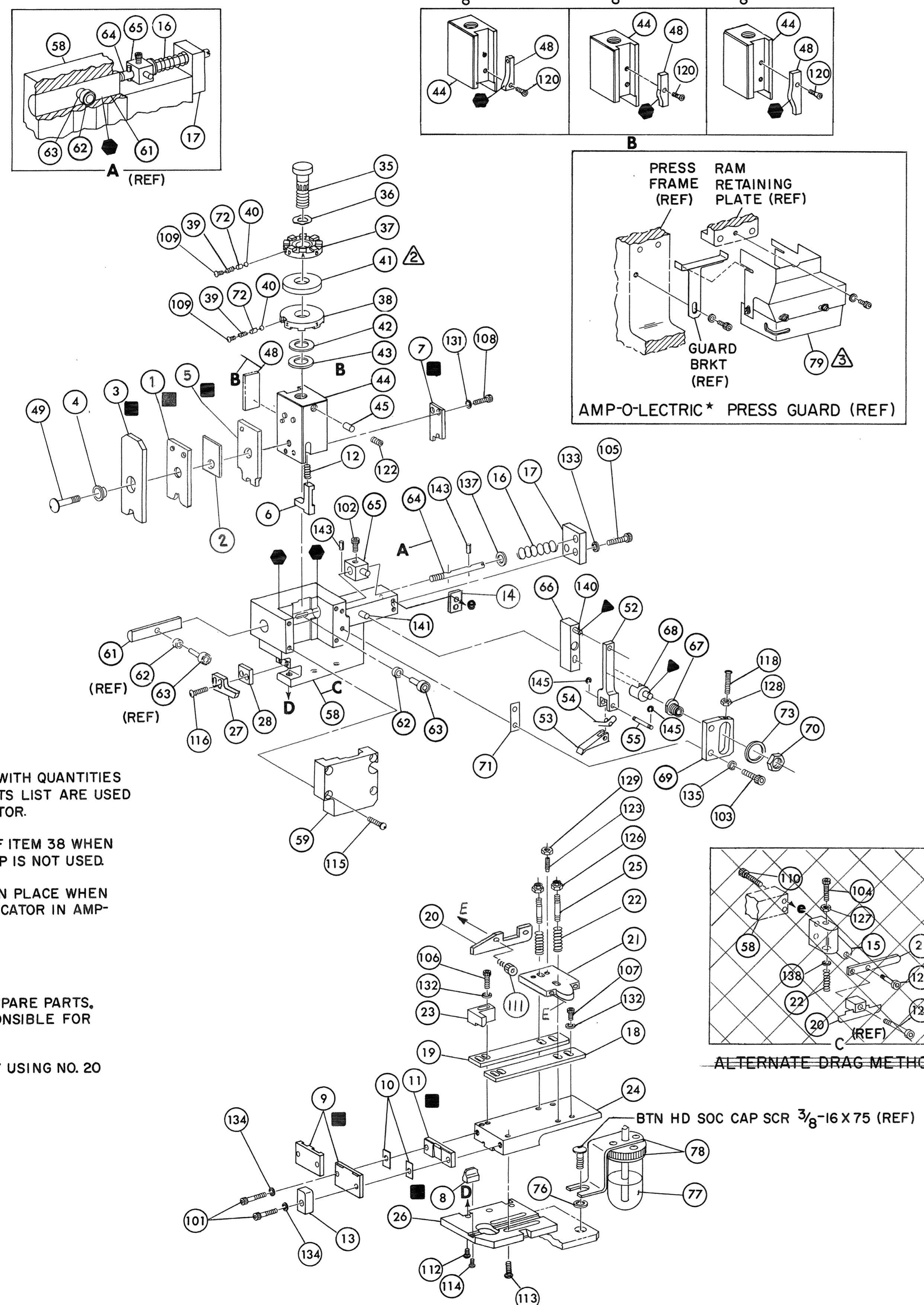

- NOTES:**
- I. ONLY THE ITEMS WITH QUANTITIES SPECIFIED ON PARTS LIST ARE USED ON THIS APPLICATOR.
 - ⚠ USED IN PLACE OF ITEM 38 WHEN INSULATION CRIMP IS NOT USED.
 - ⚠ GUARD MUST BE IN PLACE WHEN OPERATING APPLICATOR IN AMP-O-LECTRIC PRESS.
- KEY:**
- RECOMMENDED SPARE PARTS, CUSTOMER RESPONSIBLE FOR REPLACEMENT.
 - ▲ LUBRICATE DAILY USING NO. 20 MACHINE OIL.
 - GREASE LIGHTLY.

QTY	PART NO	DESCRIPTION	ITEM NO	QTY	PART NO	DESCRIPTION	ITEM NO
2	21045-3	RING, RETAINING 'C' (.187 DIA) FEED PIN	145	1	454220-1	CAP, RAM	59
			144	1	453736-1	HOUSING	58
2	5-21028-1	PIN, SLOT SPG (.12 DIA X .50) FD ADJ ROD	143				57
			142				56
1	1-21030-7	PIN, DOWEL (.187 DIA X 1.50) HOUSING	141	1	240624-1	PIN, FEED FINGER	55
1	1-21030-1	PIN, DOWEL (.187 DIA X .50) LEVER	140	1	691499-1	SPRING, FEED FINGER	54
			139	1	694921-8	FINGER, FEED	53
			138	1	240634-1	LEVER, TERMINAL	52
			137				51
			136				50
2	21024-5	WASHER, LOCK (NO 10) FEED ADJ PLATE	135	1	690686-1	BOLT, CRIMPER	49
2	21024-5	WASHER, LOCK (NO 10) SHEAR PLATES	134	1	690602-5	CAM, PRE FEED 1/8 STROKE	48
2	21024-5	WASHER, LOCK (NO 10) FEED ROD GUIDE	133				47
4	21024-4	WASHER, LOCK (NO 8) STRIP GUIDE	132				46
2	21024-4	WASHER, LOCK (NO 8) SHEAR BLADE	131	1	690191-1	PLUG, NYLON	45
			130	1	455674-5	RAM	44
2	21018-4	NUT, HEX MACH (4-40) DRAG	129	1	690125-1	WASHER, LAMINATED	43
1	21068-5	NUT, HEX MACH (6-32) FD ADJ PLATE	128	1	690124-1	WASHER, RAM	42
			127				41
2	21022-2	NUT, HEX SELF-LKG (8-32) DRAG STUD	126	2	23241-6	BALL, STEEL	40
			125	2	690170-1	SPRING, COMPRESSION	39
			124	1	690142-5	DISC, INSULATION	38
2	4-21078-8	SCR, SKT SET OVAL POINT (4-40 X .75) DRAG	123	1	5-692155-1	DISC, WIRE	37
1	21009-2	SCR, SKT SET (1/4-20 X 25) (LOC-WEL) RAM	122	1	22480-5	WASHER, SPRING	36
			121	1	690212-1	POST, RAM	35
			120				34
			119				33
1	3-21064-2	SCR, RD HD MACH (6-32 X 1.50) FEED ADJ	118		458980-	APPLICATOR, BASIC (SUB ASSY)	32
			117				31
			116				30
2	2-21002-3	SCR, BTN HD SKT CAP (8-32 X .62) STRIPPER	115				29
4	2-21002-9	SCR, BTN HD SKT CAP (10-32 X .75) HSG CAP	114				28
1	22733-8	SCR, BTN HD SKT CAP (8-32 X .38) (LOC-WEL) ANVIL	114	1	2-690451-5	SPACER, STRIPPER	27
4	3-21002-3	SCR, BTN HD SKT CAP (1/4-20 X .50) STR GDE PL	113	1	240639-2	STRIPPER	26
3	2-22733-8	SCR, BTN HD SKT CAP (1/4-20 X .62) BASE PL	112	1	455676-1	PLATE, BASE	25
2	1-21000-3	SCR, SKT HD CAP (4-40 X .25) DRAG	111	2	22354-8	DRAG, STUD	24
			110	1	455678-1	PLATE, STRIP GUIDE	23
2	2-21000-4	SCR, SKT HD CAP (6-32 X 1.00) DRAG ADAPTOR	109				22
2	23030-1	SCR, SKT HD CAP (6-32 X .25) (LOC-WEL) CP DISC	108	2	23470-5	SPRING, DRAG	21
2	2-21000-6	SCR, SKT HD CAP (8-32 X .38) SHEAR BLADE	107	1	464451-4	ARM, STOCK DRAG	20
3	2-21000-6	SCR, SKT HD CAP (8-32 X .38) STRIP GUIDE	106	1	464452-2	DRAG, STOCK	19
1	2-21000-6	SCR, SKT HD CAP (8-32 X .38) STRIP GUIDE	105	1	3-458030-9	GUIDE, STRIP (REAR)	18
2	3-21000-7	SCR, SKT HD CAP (10-32 X .75) FD ROD GUIDE	104	1	3-458031-9	GUIDE, STRIP (FRONT)	17
			103	1	454178-1	GUIDE, FEED ROD	16
1	3-21000-9	SCR, SKT HD CAP (10-32 X 1.00) DRAG SPRING	102	1	4-22284-9	SPRING, FEED RETURN	15
2	3-21000-6	SCR, SKT HD CAP (10-32 X .62) FD ADJ PLATE	101		454665-4	ADAPTER, DRAG	14
1	3-21000-4	SCR, SKT HD CAP (10-32 X .38) PIVOT BLK	79		464524-1	SPACER, DRAG ADAPTER	13
2	3-21000-8	SCR, SKT HD CAP (10-32 X .88) SHEAR PLATE	78			SPACER, HOLD DOWN	12
REF	455745-1	GUARD, WINDOW	77			SPRING, HOLD DOWN	11
1	465184-9	LUBRICATOR ASSY	76	1	453654-1	PLATE, REAR SHEAR	10
REF	852931-2	OIL, LUBRICATING	75	2	2-240645-0	SPACER, SHEAR PLATE	9
1	454406-1	SPACER, LUB BRACKET	74	1	453653-1	PLATE, FRONT SHEAR	8
			73	1	453670-4	ANVIL	7
			72	1	453656-1	BLADE, SLUG, REAR	6
			71			HOLD DOWN, TERMINAL	5
			70	1	684917-1	SHEAR BLADE, FRONT	4
			69	1	238009-1	SPACER, TUBULAR	3
			68	1	3-456135-1	CRIMPER, INSULATION	2
			67	1	455888-9	SPACER, INSULATION	1
			66	1	2-456402-6	CRIMPER, WIRE	

QTY	PART NO	DESCRIPTION	ITEM NO
1	458109-1	WASHER, FLAT (SPECIAL)	
2	690603-1	SPRING, ASSIST	
1	690517-1	SPACER	
1	22594-8	NUT, HEX	
1	240628-1	PLATE, ADJ	
1	240626-1	SHAFT, PIVOT	
1	240633-1	BUSHING	
1	455680-1	LEVER, INTERMEDIATE	
1	240629-1	BLOCK, PIVOT	
1	240632-2	SCREW, ADJ	
1	240659-3	PIN, CAM ROLLER	
1	240658-1	CAM, ROLLER	
1	454398-1	ROD, FEED	

REMARKS		NO	REV
APPL USED ON MACHINE PART NO		TO APPLY TERMINAL	
CUSTOMER NAME		114-1008	
ADDRESS		DISTRIBUTION	
CITY		ORIGINAL	
		CUSTOMER COPY	
		FIELD ENG COPY	

CRIMPING DATA				APPLICATOR WILL APPLY	
PAD LTR	CRIMP HEIGHT	WIRE SIZE	WIRE STRIP LENGTH		
A	.041	20			G/323
B	.037	(1)22 OR (2)24	5		
C	.034	24			
D	NOT USED				
CRIMP	SIZE	TYPE	FEED	APPL INST	
WIRE	.055	F			
INSUL	.110	O	.535	A1 8039	
WIRE RANGE		INSULATION RANGE		PRESS NO	
24-20		.040-.100		565435-5	
REMARKS AMP-O-LECTRIC PRE FEED					
REF: IDENT. PLATE 461264-1					