

REV.	DATE	DESCRIPTION
NC	10/03/03	INITIAL RELEASE

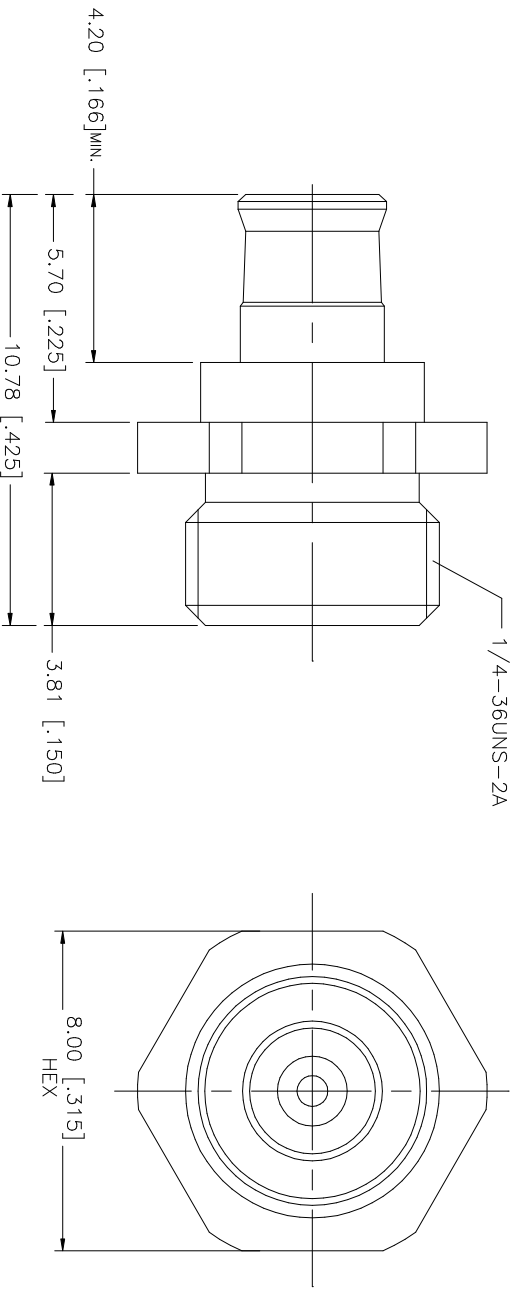

NO.	DESCRIPTION	MATERIAL	FINISH	QTY	UNLESS OTHERWISE SPECIFIED, DIMENSIONS ARE IN MILLIMETERS. DIMENSIONS IN [] ARE IN INCHES AND FOR CUSTOMER REFERENCE ONLY. TOLERANCES FOR MILLIMETERS ARE: 0.3 - 8mm ± 0.20mm 8 - 30mm ± 0.40mm 30 - 120mm ± 0.50mm UNLESS OTHERWISE SPECIFIED, TOLERANCES FOR INCHES ARE: .020 - .315 = ± 0.007" .315 - 1.180 = ± 0.015" 1.180 - 4.724 = ± 0.020"	DO NOT SCALE DRAWING	CAD FILE	APPROVALS	DATE	DWG. NO.	REV.	NC	SIZE	SCALE			
8										252186.DWG			A	NA			
7																	
6																	
5																	
4																	
3	CONTACT PIN	BER. COPPER	GOLD	1													
2	INSULATOR BODY	TEFLON BRASS	NATURAL GOLD	1													
1																	
<p style="text-align: center;">Amphenol Connex</p> <p style="text-align: center;">PART DESCRIPTION MCX PLUG TO MCX JACK ADAPTER</p> <p style="text-align: center;">PART NO. 252186</p>										DWG. NO.	252186.DWG	REV.	NC	SIZE	A	SCALE	NA