

REV	DESCRIPTION	DATE

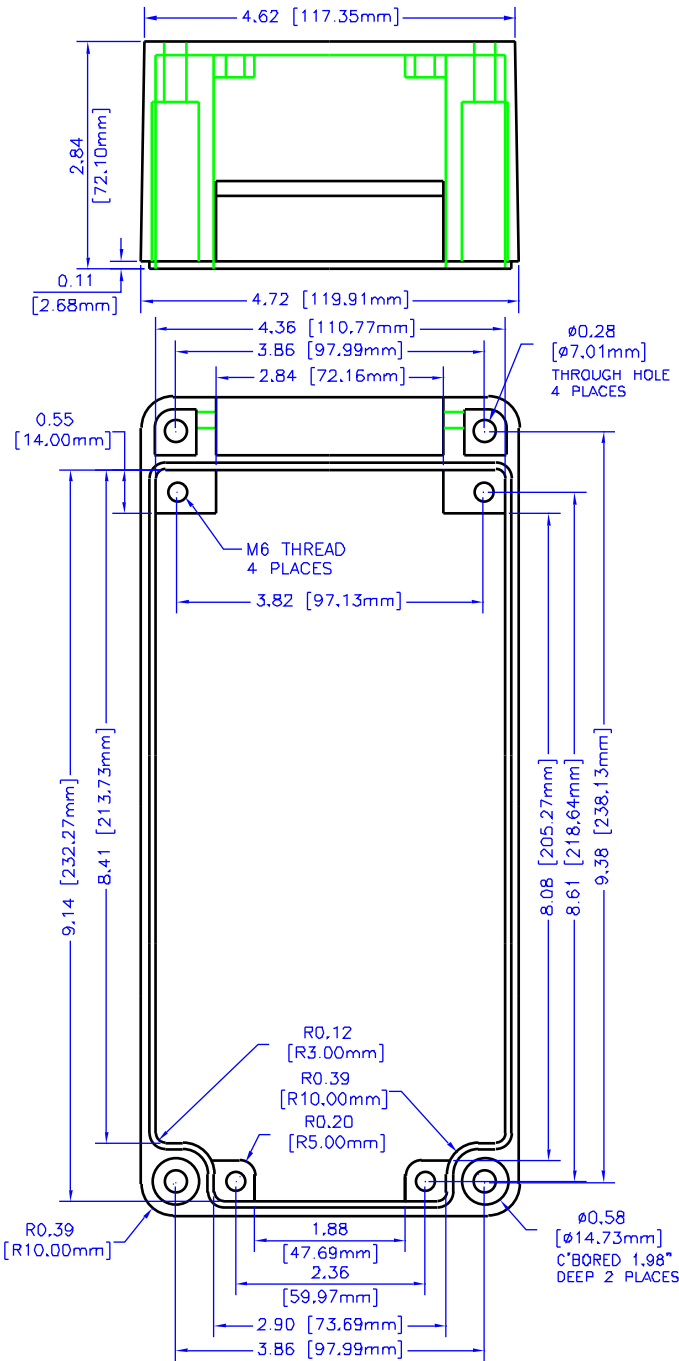

BOX VIEW

NOTES

MATERIAL TWO PIECE MOLDED FIBERGLASS REINFORCED POLYESTER CONSTRUCTION, COMES WITH HINGED POLYFIBER COVER WITH A ACRYLIC WINDOW, RECESSED NEOPRENE GASKET WITH TONGUE AND GROVE CONSTRUCTION, THREADED STAINLESS STEEL INSERTS PROVIDED FOR INTERNAL MOUNTING.

COLORS LIGHT GRAY (RAL 7032)

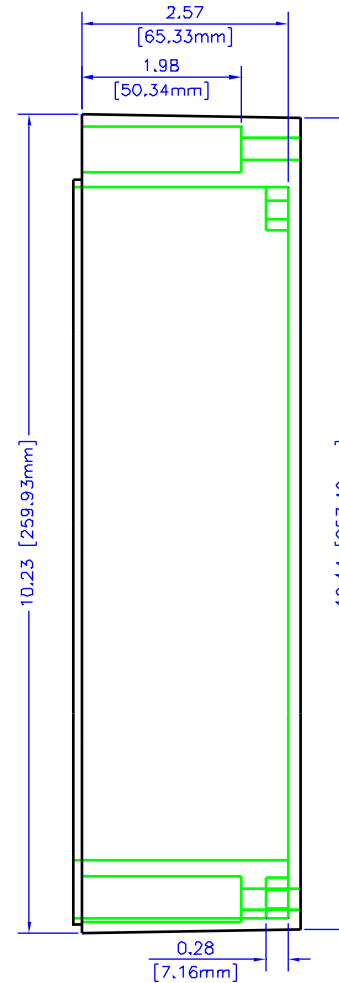

UNLESS OTHERWISE SPECIFIED
DIMENSIONS ARE IN INCHES
X +/- .1
XX +/- .02
XXX +/- .010
DIPS +/- .005
ANGLES +/- 5 DEG
NOTE:
RENDERING CLEAR PROPRIETARY RIGHTS TO THE MATERIAL ON THIS DRAWING. IT IS INTENDED TO BE USED AS A REFERENCE FOR ENGINEERING INFORMATION ONLY. THIS INFORMATION MAY NOT BE USED TO MANUFACTURE PRODUCT WITHOUT WRITER PERMISSION FROM HAMMOND MANUFACTURING.



**HAMMOND
MANUFACTURING**

WEB: WWW.HAMMONDMFG.COM

TITLE	
HAMMOND R130 SERIES POLYESTER ENCLOSURE	
DRAWN BY	MJM
DATE	12/08/01
SCALE	PAGE 1 OF 2
PART NUMBER	R131-124-000

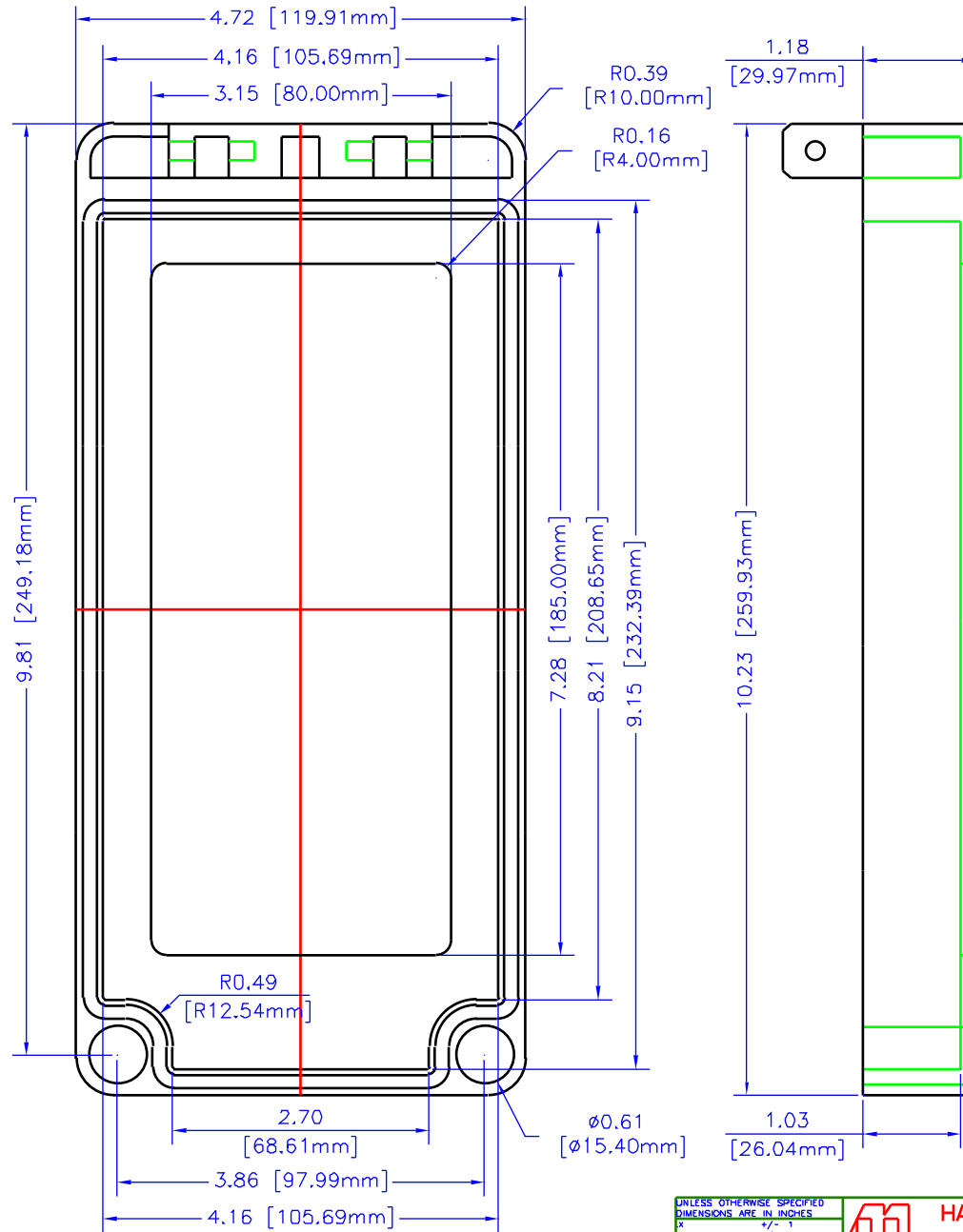

LID VIEW

UNLESS OTHERWISE SPECIFIED
 DIMENSIONS ARE IN INCHES
 X +/- .1
 XX +/- .02
 XXX +/- .010
 SLITS +/- .005
 ANGLES +/- .5 DEG
 NOTICE
 HAMMOND MANUFACTURING WARRIOR WAREHOUSE
 1000 W. 10TH AVENUE
 DENVER, CO 80202
 (303) 733-1100
 WWW.HAMMONDMFG.COM

**HAMMOND
 MANUFACTURING**

WEB: WWW.HAMMONDMFG.COM

TITLE		HAMMOND R130 SERIES POLYESTER ENCLOSURE	
DRAWN BY	MJM	DATE	12/08/01
SCALE		PAGE	2 OF 2
PART NUMBER		R131-124-000	