

PLEASE CHECK WWW.MOLEX.COM FOR LATEST PART INFORMATION

Part Number: [19010-0031](#)
Status: **Active**
Description: Krimptite™ Piggyback Quick Disconnect, Tab 6.35 x 0.81mm, 18-22 AWG

Documents:

[Drawing \(PDF\)](#) [Product Specification PS-19902-015 \(PDF\)](#)
[Product Specification PS-19902-011 \(PDF\)](#) [RoHS Certificate of Compliance \(PDF\)](#)

General

Product Family	Quick Disconnects
Series	19010
Crimp Quality Equipment	Yes
Product Name	Krimptite™
Type	Quick Disconnect
UPC	822350947800

Physical

Barrel Type	Closed
Gender	Female
Glow-Wire Compliant	No
Insulation	None
Lock to Mating Part	No
Net Weight	0.897/g
Orientation	Straight
Packaging Type	Adhesive Tape on Reel
Polarized to Mating Part	Yes
Tab Thickness	0.81mm
Tab Width	6.35mm
Temperature Range - Operating	149°C
Wire Insulation Diameter	2.79mm max.
Wire Size AWG	18, 20, 22
Wire Size mm²	0.35 - 0.80

Electrical

Voltage - Maximum	N/A
-------------------	-----

Material Info

Old Part Number	AA-1301T
-----------------	----------

Reference - Drawing Numbers

Product Specification	PS-19902-011, PS-19902-015
Sales Drawing	SD-19010-001

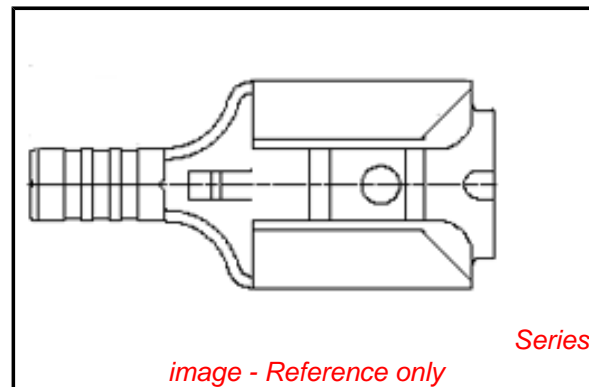

EU RoHS

**ELV and RoHS
Compliant**

REACH SVHC

Not Reviewed

Low-Halogen Status

Not Reviewed

China RoHS



**Need more information on product
environmental compliance?**

Email productcompliance@molex.com
 For a multiple part number RoHS Certificate of
 Compliance, [click here](#)

Please visit the [Contact Us](#) section for any
 non-product compliance questions.

Search Parts in this Series

19010Series