

DO NOT SCALE FROM THIS PRINT

EHT-1XX-01-X-D-XX-SR-XX-XX-X-XX

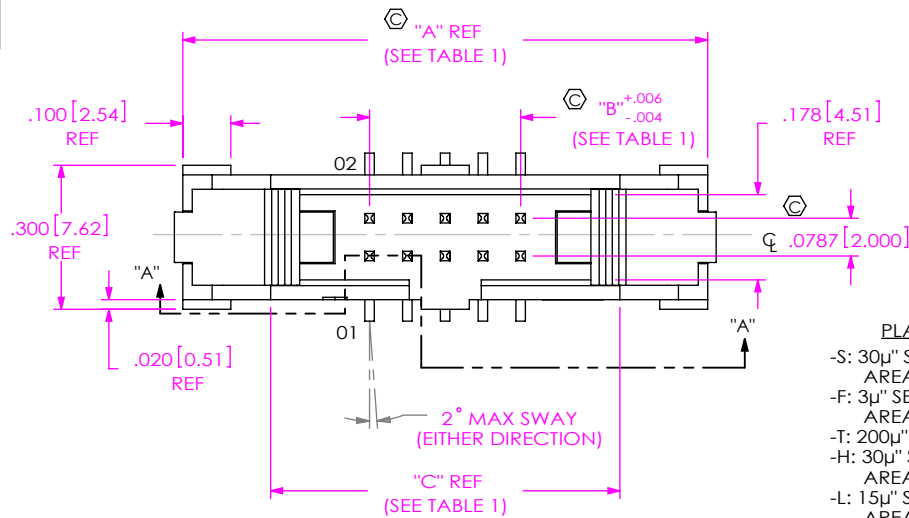

NO OF POSITIONS
-05 THRU -25

LEAD STYLE
-01

PLATING SPECIFICATION
 -S: 30μ" SELECTIVE GOLD IN CONTACT AREA, MATTE TIN ON TAIL.
 -F: 3μ" SELECTIVE GOLD IN CONTACT AREA, MATTE TIN ON TAIL.
 -T: 200μ" MATTE TIN ON ENTIRE CONTACT.
 -H: 30μ" SELECTIVE GOLD IN CONTACT AREA, 3μ" SELECTIVE GOLD ON TAIL.
 -L: 15μ" SELECTIVE GOLD IN CONTACT AREA, MATTE TIN ON TAIL.

ROW SPECIFICATION
-D: DOUBLE

OPTION 3
-TR: TAPE & REEL

OPTION 2
 -P: PICK & PLACE PAD (FOR -SM ONLY, USE PPP-24) (USE PPP-55 WITH -SM-TR OPTION) (SEE SHT 3, FIG 5) (NOT AVAILABLE WITH -LC)
 -K: POLYIMIDE FILM PAD (SEE SHT 2, FIG 4) (NOT AVAILABLE WITH -LC) (FOR -SM ONLY)

POLARIZATION OPTION
-XX= PIN OMITTED

OPTION 1
 -LC: LOCKING CLIP (SEE NOTE 8) (FOR -SM ONLY, SEE NOTE 8) (NOT AVAILABLE WITH -P OR -K)

-SR STRAIN RELIEF

TAIL OPTION
 -RA: RIGHT ANGLE
 -SM: SURFACE MOUNT (LEAVE BLANK FOR THRU HOLE)

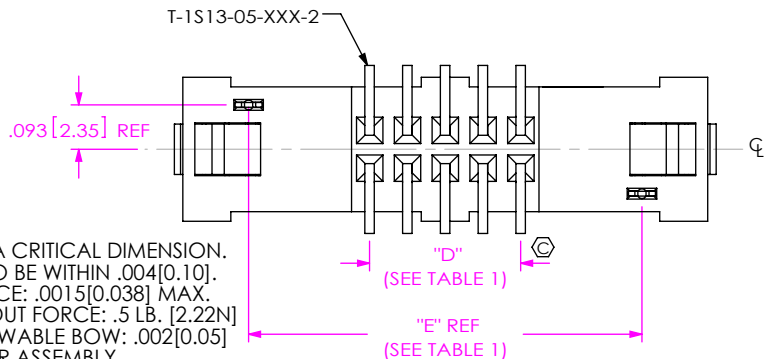
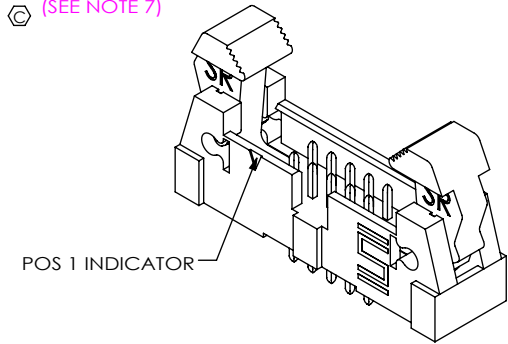
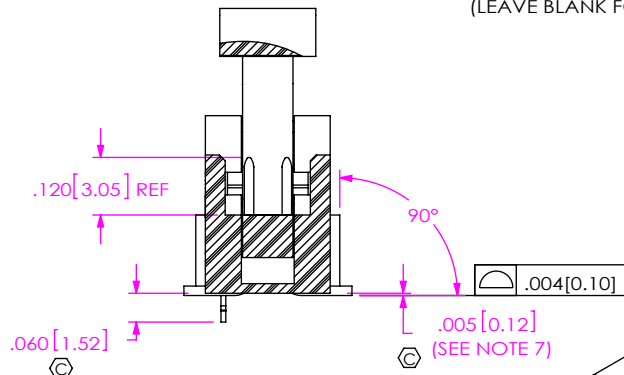
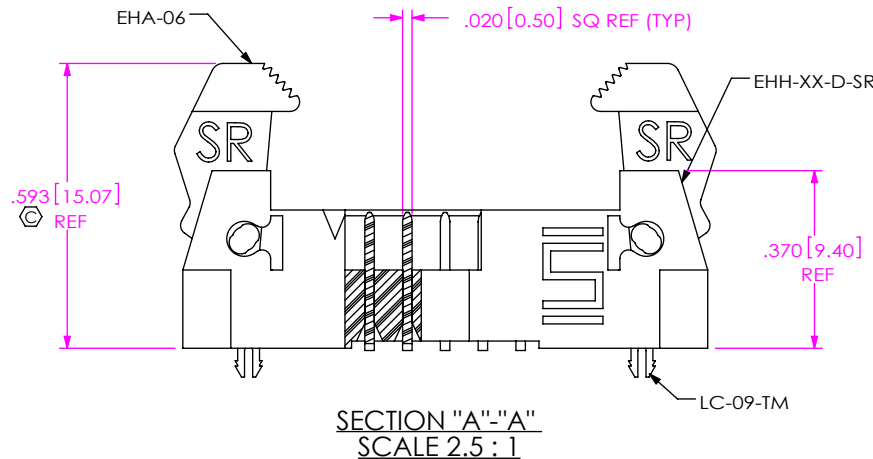

NOTES:

1. Ⓢ REPRESENTS A CRITICAL DIMENSION.
2. COPLANARITY TO BE WITHIN .004 [0.10].
3. BURR ALLOWANCE: .0015 [0.038] MAX.
4. MINIMUM PUSHOUT FORCE: .5 LB. [2.22N]
5. MAXIMUM ALLOWABLE BOW: .002 [0.05] INCH/INCH AFTER ASSEMBLY.
6. MAXIMUM PIN ROTATION IN BODY: 2°
7. MEASURE AT BEND
8. DUE TO THE HIGH AMOUNT OF INSERTION FORCE NEEDED, THE -LC OPTION IS NOT COMPATIBLE WITH AUTO PLACEMENT. SAMTEC RECOMMENDS MANUAL PLACEMENT FOR ALL ASSEMBLIES WITH THE -LC OPTION.

UNLESS OTHERWISE SPECIFIED, DIMENSIONS ARE IN INCHES. TOLERANCES ARE:
 DECIMALS ANGLES
 .XX: ±.01 [0.3] 2°
 .XXX: ±.005 [0.13]
 .XXXX: ±.0020 [0.051]

PROPRIETARY NOTE
 THIS DOCUMENT CONTAINS INFORMATION CONFIDENTIAL AND PROPRIETARY TO SAMTEC, INC. AND SHALL NOT BE REPRODUCED OR TRANSFERRED TO OTHER DOCUMENTS OR DISCLOSED TO OTHERS OR USED FOR ANY PURPOSE OTHER THAN THAT WHICH IT WAS OBTAINED WITHOUT THE EXPRESSED WRITTEN CONSENT OF SAMTEC, INC.



520 PARK EAST BLVD, NEW ALBANY, IN 47150
 PHONE: 812-944-6733 FAX: 812-948-5047
 e-Mail: info@SAMTEC.com code: 55322

MATERIAL: DO NOT SCALE DRAWING SHEET SCALE: 5:2
 INSULATOR: VECTRA E130, COLOR: NATURAL
 TERMINAL: PHOS BRONZE
 MAX FLASH ALLOWED: .002 [0.05]
 MAX GATE VESTIGE: .002 [0.05]

DESCRIPTION:
EHT EJECTOR HEADER ASSEMBLY

DWG. NO.
EHT-1XX-01-X-D-XX-SR-XX-XX-X-XX

BY: CHADP 08/04/2008 SHEET 1 OF 3

FIG 2
(EHT-105-01-XX-D-SR SHOWN)
(SAME AS FIG.1 DIFFERENT AS SHOWN)

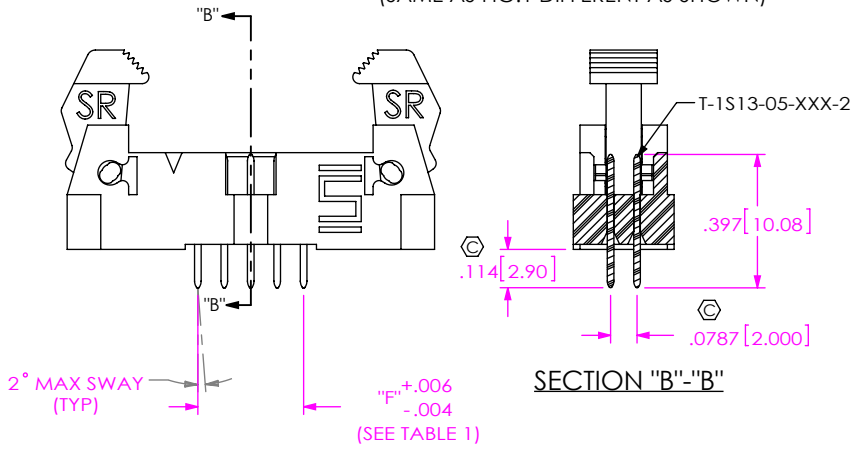
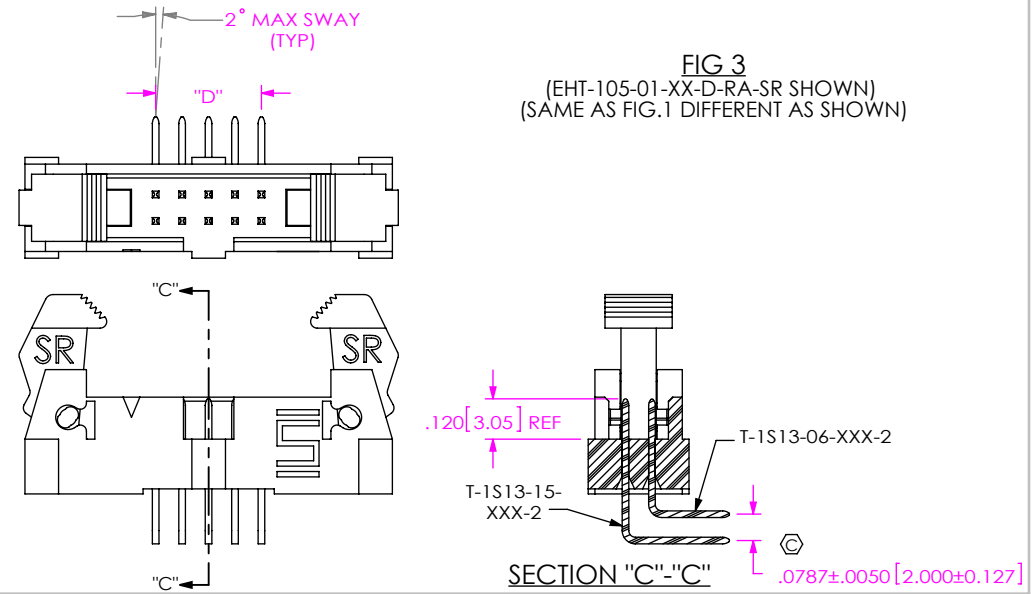
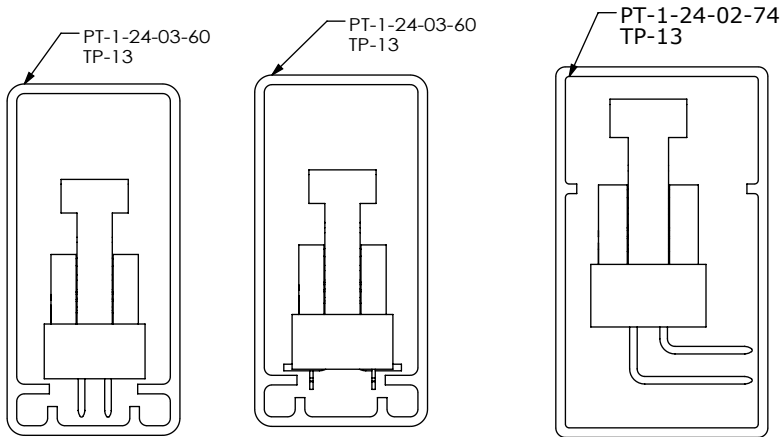

FIG 3
(EHT-105-01-XX-D-RA-SR SHOWN)
(SAME AS FIG.1 DIFFERENT AS SHOWN)



PACKAGING VIEWS:
(LOAD PARTS WITH POSITION # 1 INDICATOR
IN SAME DIRECTION AS ARROW ON TUBE)



THRU HOLE OPTION

-SM OPTION

-RA OPTION

-RA IN-PROCESS 1
FILL BODY WITH PIN

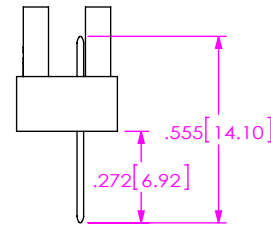

-RA IN-PROCESS 2
BEND TAIL

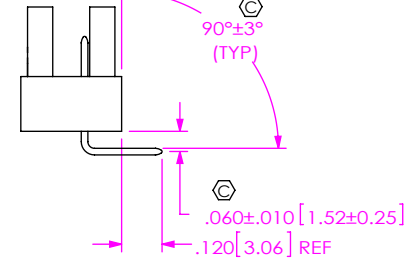

-RA IN-PROCESS 3
BEND TAILS

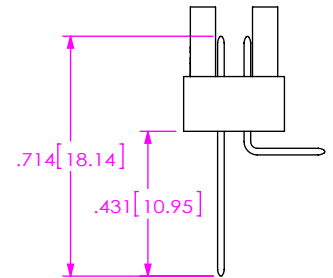
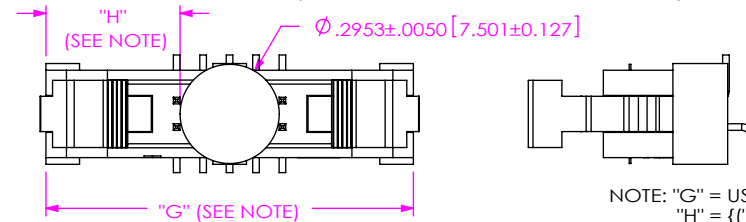
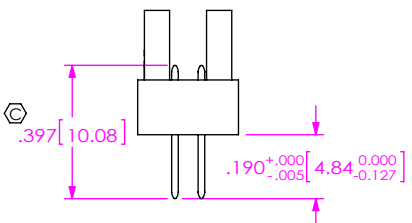

FIG 4
-K: OPTION (POLYIMIDE FILM PAD)
(SAME AS FIG 1 DIFFERENT AS SHOWN)



NOTE: "G" = USE MEASURED DIMENSION (REF)
"H" = {("G" - .2953[7.50])/2} ± .020[0.51]}

-SM IN-PROCESS 1
FILL BODY WITH PINS



-SM IN-PROCESS 2
BEND TAILS

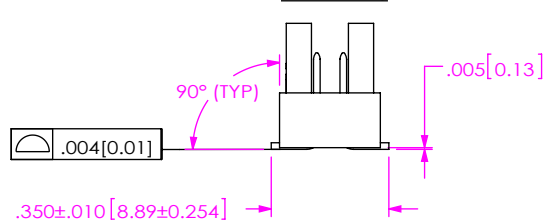

PROPRIETARY NOTE

THIS DOCUMENT CONTAINS INFORMATION
CONFIDENTIAL AND PROPRIETARY TO
SAMTEC, INC. AND SHALL NOT BE REPRODUCED
OR TRANSFERRED TO OTHER DOCUMENTS OR
DISCLOSED TO OTHERS OR USED FOR ANY
PURPOSE OTHER THAN THAT WHICH IT WAS
OBTAINED WITHOUT THE EXPRESSED WRITTEN
CONSENT OF SAMTEC, INC.

DO NOT SCALE DRAWING

SHEET SCALE: 1:0.571429



520 PARK EAST BLVD, NEW ALBANY, IN 47150
PHONE: 812-944-6733 FAX: 812-948-5047
e-Mail: info@SAMTEC.com code: 53322

DESCRIPTION:
EHT EJECTOR HEADER ASSEMBLY
DWG. NO.
EHT-1XX-01-X-D-XX-SR-XX-XX-X-XX
BY: CHADP 08/04/2008 SHEET 2 OF 3

IN-PROCESS
ARM ASSEMBLY & ROTATION

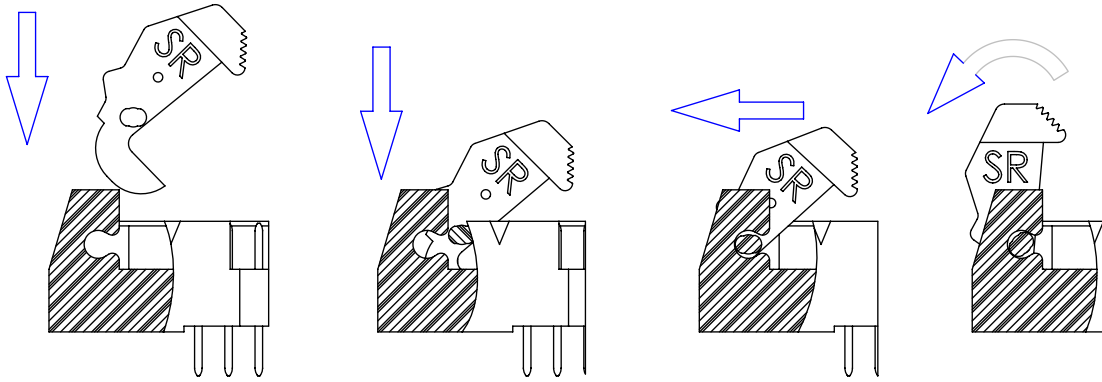

CRITICAL DIMENSION INSPECTION INSTRUCTION TABLE

ASSEMBLY OPERATION	IN-PROCESS INSPECTION
FILL T-1S13	C1, C2,C3,C4,C5,C7,C10,C11,C14,C15,C16,C17,C20
FORM T-1S13	C2,C6,C8,,C12,C13,C18,C19,C20,C22,C23
2ND PRESS	C25
INSERT EHA-06	C5
FILL LC-09	C9

FIG 5
-PPP: PICK AND PLACE PAD
(SAME AS FIG 1 DIFFERENT AS SHOWN)

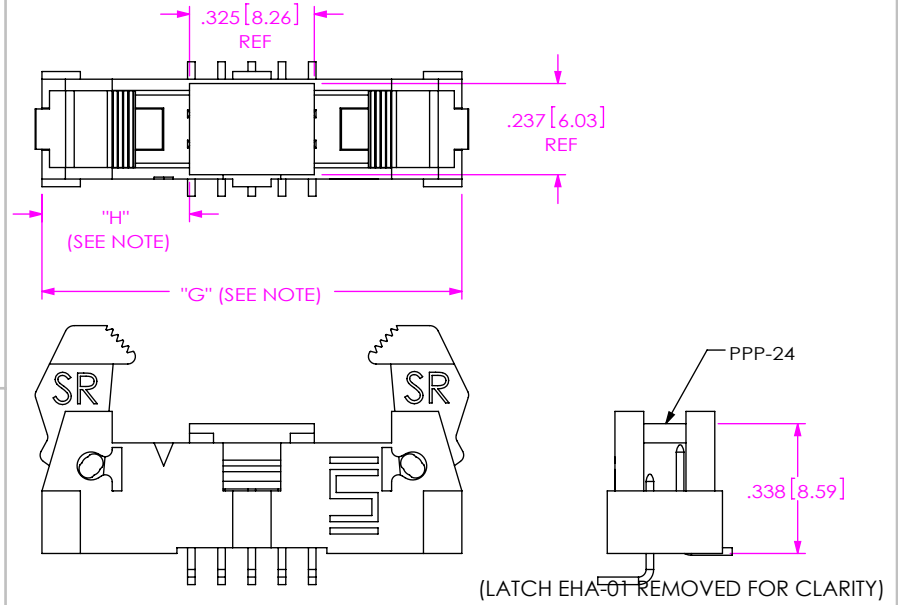

NOTE: "G" = USE MEASURED DIMENSION (REF)
"H" = {"G" -.325[8.26]/2} ±.020[0.51]

TABLE 1

No. OF POS.	"A"	"B"	"C"	"D"	"E"	"F"
-05	1.094 [27.79]	0.315 [8.00]	.728 [18.49]	0.315 [8.00]	0.820 [20.83]	0.315 [8.00]
-06	1.173 [29.79]	0.394 [10.00]	.807 [20.49]	0.394 [10.00]	0.899 [22.83]	0.394 [10.00]
-07	1.251 [31.79]	0.472 [12.00]	.885 [22.49]	0.472 [12.00]	0.977 [24.83]	0.472 [12.00]
-08	1.330 [33.79]	0.551 [14.00]	.964 [24.49]	0.551 [14.00]	1.056 [26.83]	0.551 [14.00]
-09	1.409 [35.79]	0.630 [16.00]	1.043 [26.49]	0.630 [16.00]	1.135 [28.83]	0.630 [16.00]
-10	1.488 [37.79]	0.709 [18.00]	1.122 [28.49]	0.709 [18.00]	1.214 [30.83]	0.709 [18.00]
-11	1.566 [39.79]	0.787 [20.00]	1.200 [30.49]	0.787 [20.00]	1.292 [32.83]	0.787 [20.00]
-12	1.645 [41.79]	0.866 [22.00]	1.279 [32.49]	0.866 [22.00]	1.371 [34.83]	0.866 [22.00]
-13	1.724 [43.78]	0.945 [24.00]	1.358 [34.49]	0.945 [24.00]	1.450 [36.83]	0.945 [24.00]
-14	1.803 [45.78]	1.023 [26.00]	1.437 [36.49]	1.023 [26.00]	1.529 [38.83]	1.023 [26.00]
-15	1.881 [47.78]	1.102 [28.00]	1.515 [38.49]	1.102 [28.00]	1.607 [40.83]	1.102 [28.00]
-16	1.960 [49.78]	1.181 [30.00]	1.594 [40.49]	1.181 [30.00]	1.686 [42.83]	1.181 [30.00]
-17	2.039 [51.78]	1.260 [32.00]	1.673 [42.49]	1.260 [32.00]	1.765 [44.83]	1.260 [32.00]
-18	2.117 [53.78]	1.338 [34.00]	1.752 [44.49]	1.338 [34.00]	1.844 [46.83]	1.338 [34.00]
-19	2.196 [55.78]	1.417 [36.00]	1.830 [46.49]	1.417 [36.00]	1.922 [48.83]	1.417 [36.00]
-20	2.275 [57.78]	1.496 [38.00]	1.909 [48.49]	1.496 [38.00]	2.001 [50.83]	1.496 [38.00]
-21	2.353 [59.78]	1.575 [40.00]	1.988 [50.49]	1.575 [40.00]	2.080 [52.83]	1.575 [40.00]
-22	2.432 [61.78]	1.653 [42.00]	2.067 [52.49]	1.653 [42.00]	2.159 [54.83]	1.653 [42.00]
-23	2.511 [63.77]	1.732 [44.00]	2.145 [54.49]	1.732 [44.00]	2.237 [56.83]	1.732 [44.00]
-24	2.590 [65.77]	1.811 [46.00]	2.224 [56.49]	1.811 [46.00]	2.316 [58.83]	1.811 [46.00]
-25	2.668 [67.77]	1.890 [48.00]	2.303 [58.49]	1.890 [48.00]	2.395 [60.83]	1.890 [48.00]

PROPRIETARY NOTE
THIS DOCUMENT CONTAINS INFORMATION
CONFIDENTIAL AND PROPRIETARY TO
SAMTEC, INC. AND SHALL NOT BE REPRODUCED
OR TRANSFERRED TO OTHER DOCUMENTS OR
DISCLOSED TO OTHERS OR USED FOR ANY
PURPOSE OTHER THAN THAT WHICH IT WAS
OBTAINED WITHOUT THE EXPRESSED WRITTEN
CONSENT OF SAMTEC, INC.

DO NOT SCALE DRAWING
SHEET SCALE: 2:1



520 PARK EAST BLVD, NEW ALBANY, IN 47150
PHONE: 812-944-6733 FAX: 812-948-5047
e-Mail: info@SAMTEC.com code: 55322

DESCRIPTION:
EHT EJECTOR HEADER ASSEMBLY
DWG. NO.
EHT-1XX-01-X-D-XX-SR-XX-XX-X-XX
BY: CHADP 08/04/2008 SHEET 3 OF 3