

REVISIONS				
P.	LTN	DESCRIPTION	DATE	DWN APVD
B		REVISED PER ECR 07-029464	04JAN2008	DD DZ
B1		REVISED PER ECO 15-006720	07MAY2015	DD RL

KEYING OPTION
"C"

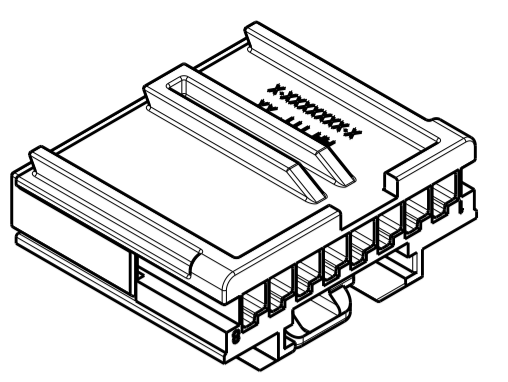

SCALE 2:1

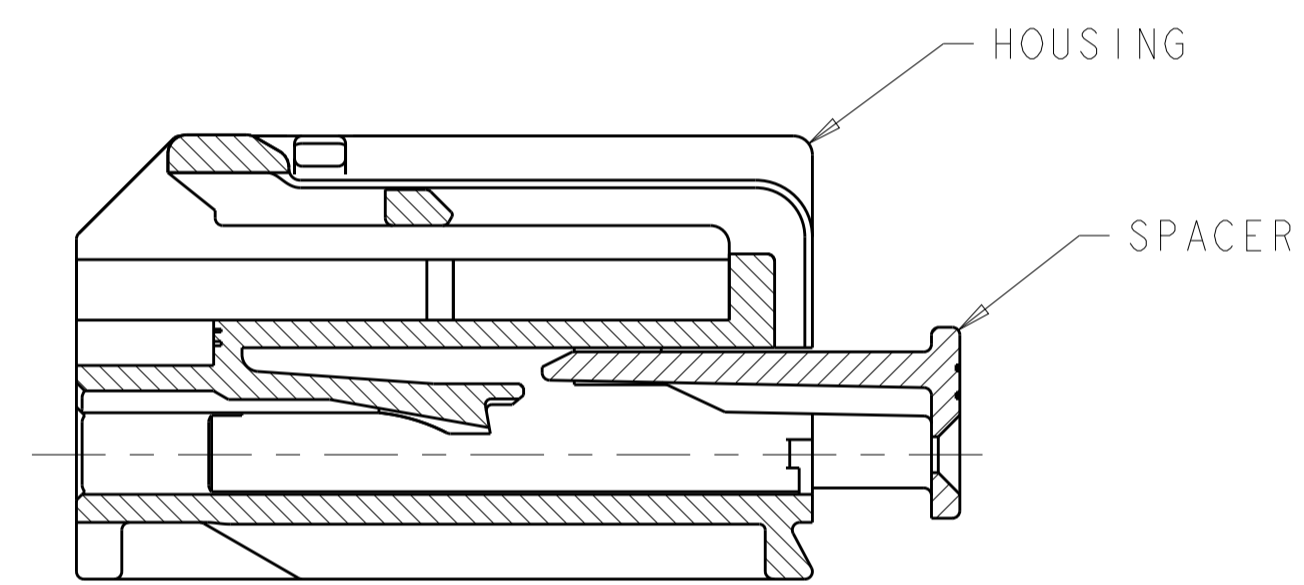
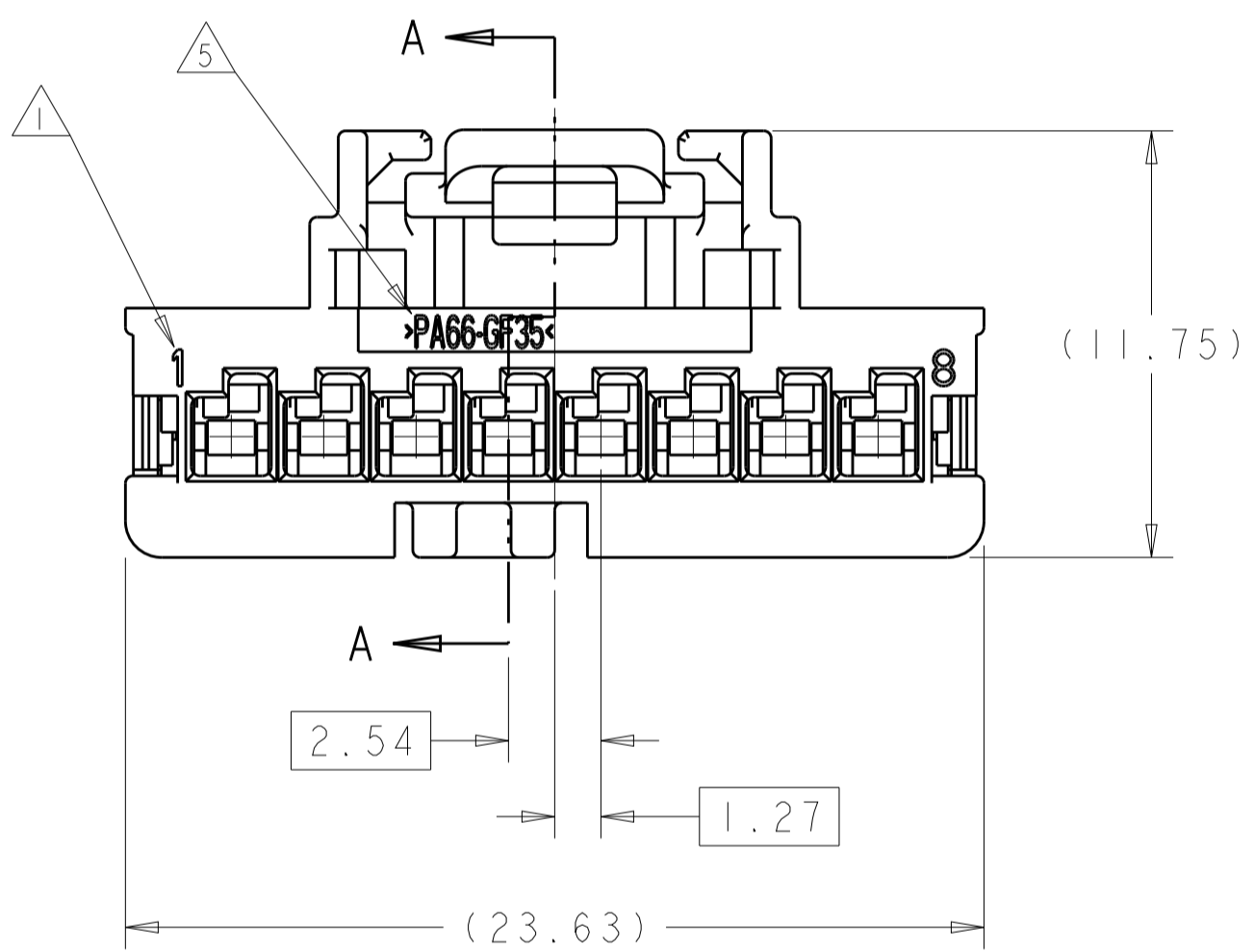
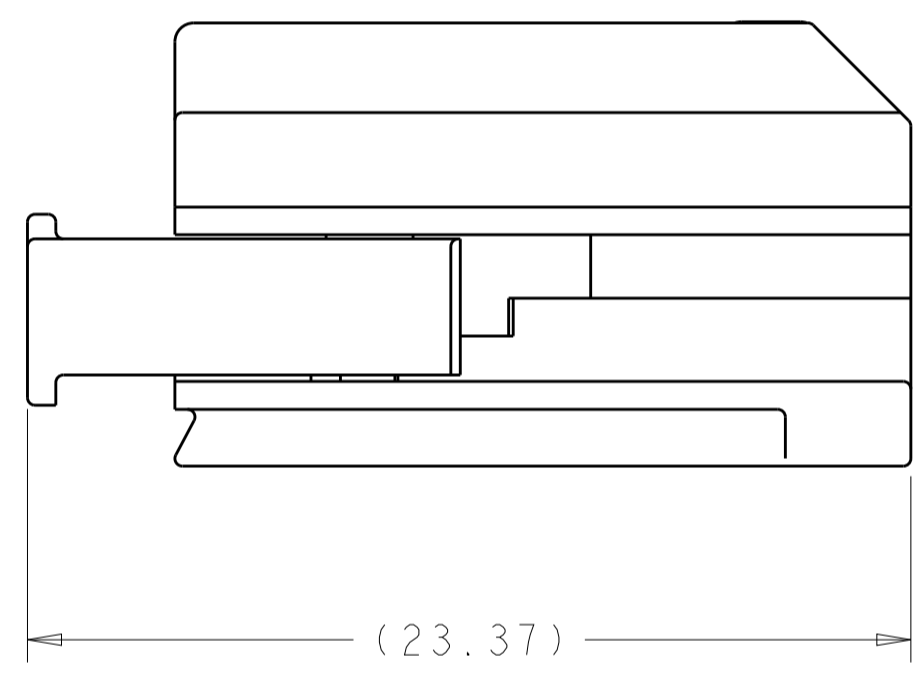
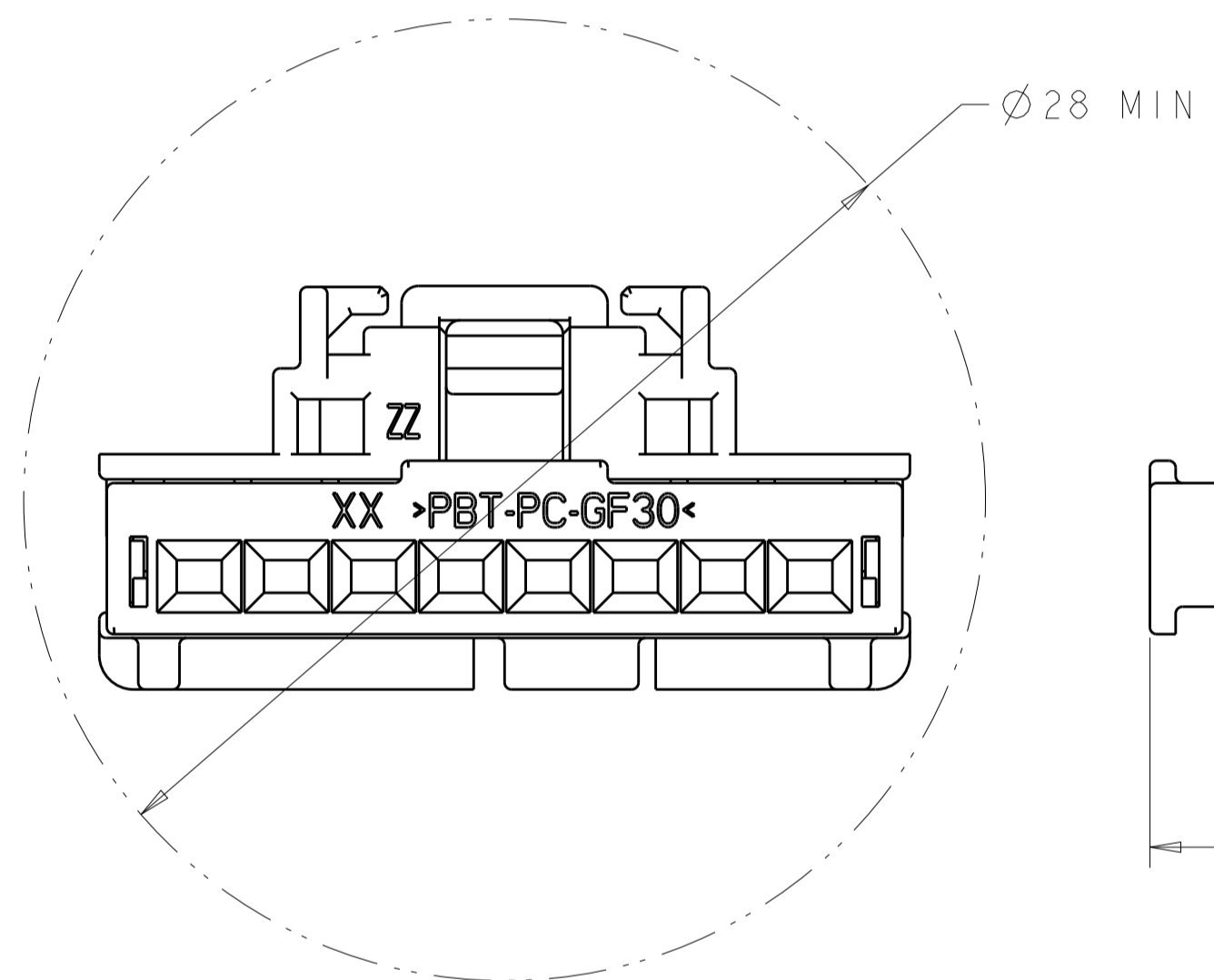
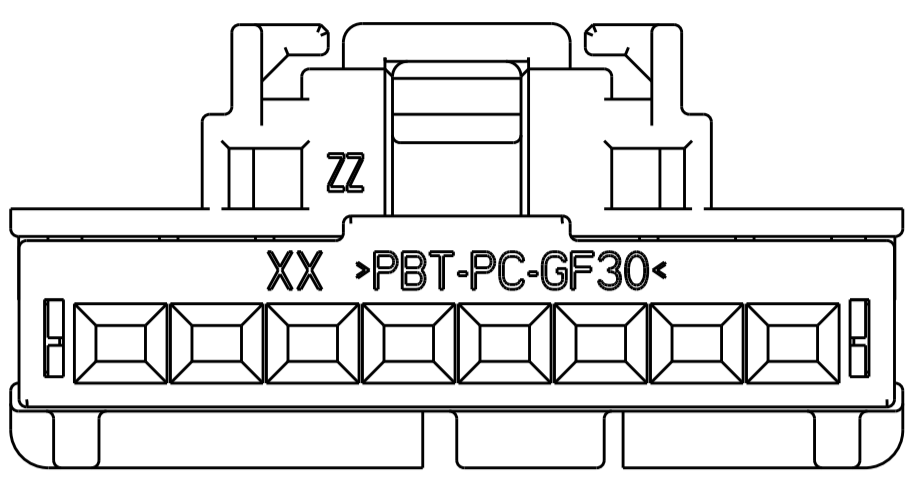

SECTION A-A

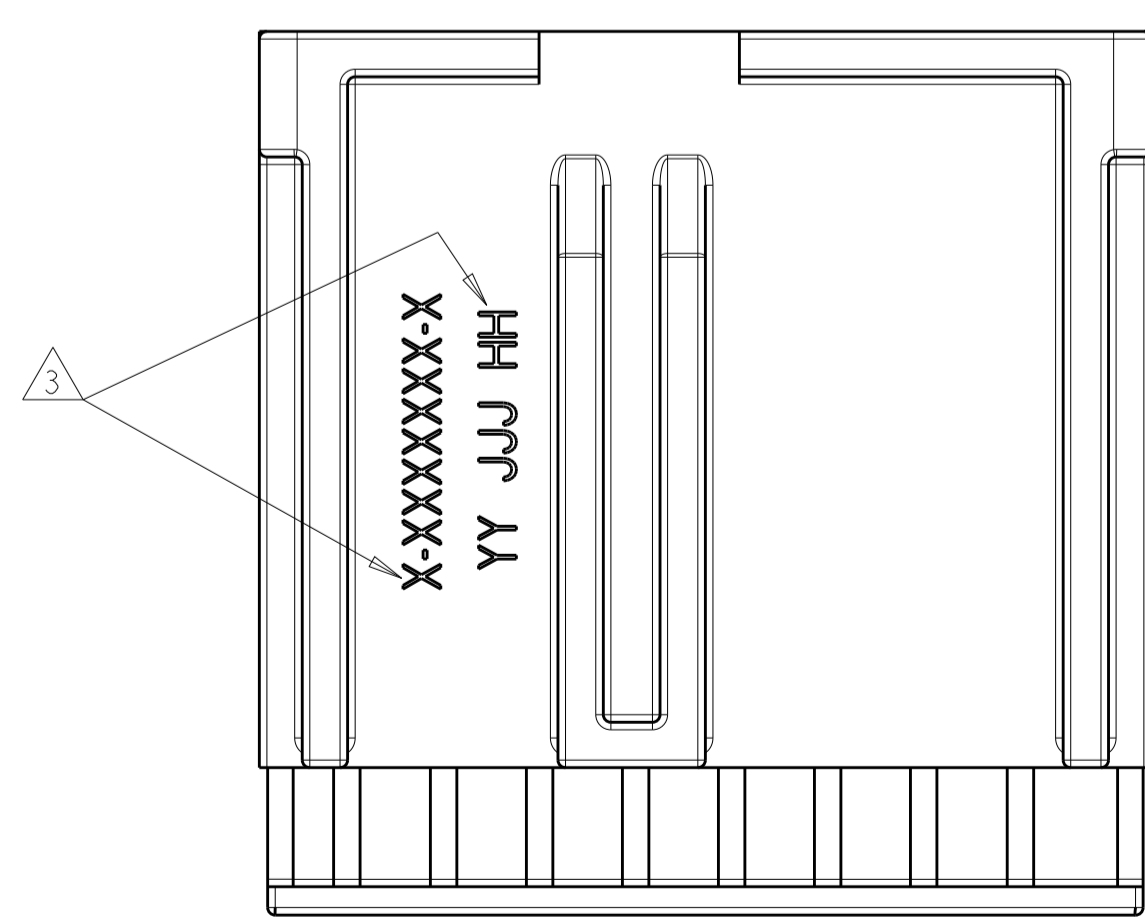
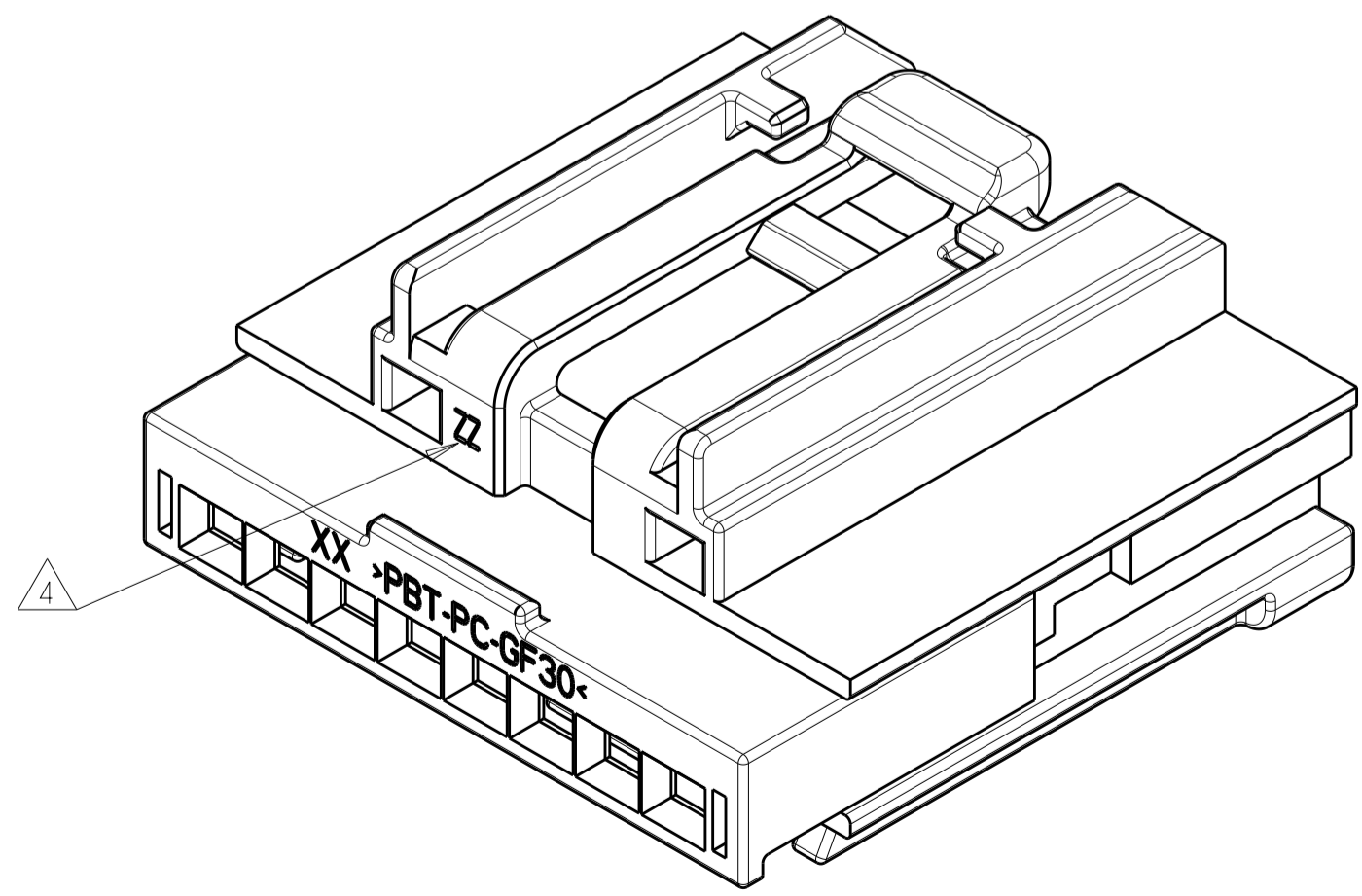

- △ TERMINAL CAVITY ID.
- 2. SPACER IS SHIPPED IN PRE-ASSEMBLY POSITION.
- △ 3 PART NUMBER AND DATE CODE.
- △ 4 MOLD CAVITY ID.
- △ 5 MATERIAL IDENTIFICATION.
- 6. PACKAGING: CONNECTOR ASSEMBLIES BULK PACKED IN CARDBOARD BOX.
- 7. DURING SHIPPING AND HANDLING THE TPA MAY BE DISPLACED TO IT'S LOCKED POSITION. THE CONNECTOR CAN BE RETURNED TO IT'S PROPER FUNCTION USING IS SHEET 408-10104.
- 8. APPLICABLE TERMINAL PART NUMBERS (SOLD SEPARATELY) GOLD APPLICATIONS 1393364 AND 1393365. TIN APPLICATIONS 1393366 AND 1393367 FOR TERMINATION AND REELING OPTIONS, SEE DRAWINGS: 1393364, 1393365, 1393366 AND 1393367.

"C"	PBT	RED	NYLON	BLACK	1488903-1
KEY	MATERIAL	COLOR	MATERIAL	COLOR	PART NUMBER
	SPACER		HOUSING		

THIS DRAWING IS A CONTROLLED DOCUMENT.		DWN A. SHUMAN 13NOV2003	TE Connectivity NAME 1X8 GET, UNSEALED, PLUG ASSEMBLY WITH MODIFIED THUMBPAD SIZE CAGE CODE DRAWING NO RESTRICTED TO A100779C=1488903
DIMENSIONS:		CHK D. REVAK 10FEB2004	
TOLERANCES UNLESS OTHERWISE SPECIFIED:		APVD D. REVAK 10FEB2004	
mm		PRODUCT SPEC	
0 PLC ±		APPLICATION SPEC	
1 PLC ±		WEIGHT	
2 PLC ±		CUSTOMER DRAWING	
3 PLC ±		SCALE 5:1	
4 PLC ±		SHEET 1 OF 1	
ANGLES ±		REV B1	
FINISH			