

POS. 1 DESIGNATE  
PIN #1 LOCATION

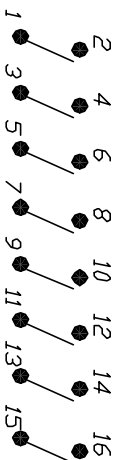
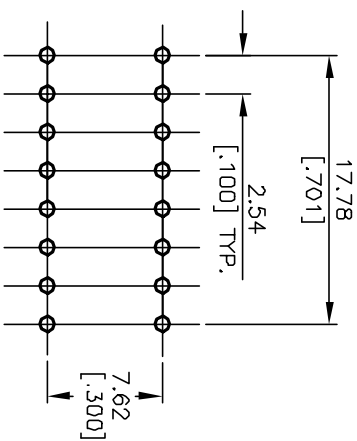
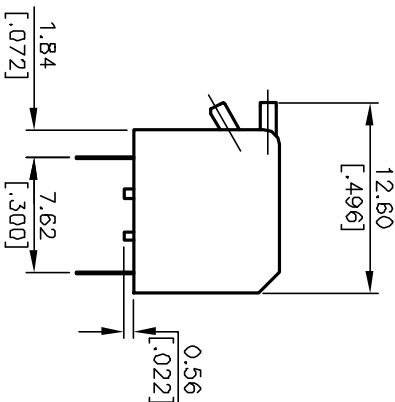
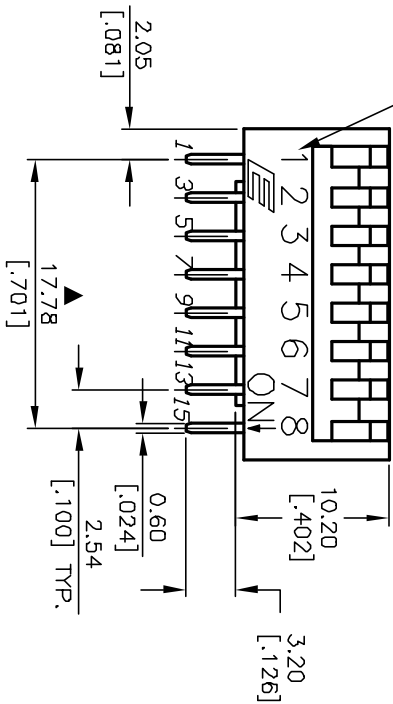

CONTACT CONFIGURATION

\* (Pos. 1 Denotes Pin No. 1)

RECOMMEND P.C.B. LAYOUT - FOR 8 POS.

NOTES:

1. ALL DIMENSIONS IN MM
2. GENERAL TOLERANCE: X.X=±0.4  
X.XX=±0.25
3. TERM. NOS. FOR REFERENCE ONLY.
4. CONTACT RATINGS: 25mA @24VDC.
5. MATERIAL: (TERMINALS/CONTACTS):  
PHOSPHOR BRONZE w/Gold Plate over  
Nickel Plate
6. INSULATION RESISTANCE:  
100Mega-ohms min @500VDC
7. CONTACT RESISTANCE (INITIAL):  
50mILLI-ohms @2-4VDC @100ma
8. OPERATING FORCE: 1000gf max.
9. TRAVEL: 2mm typical
- ▲ 10. SWITCHES SUPPLIED IN DISPENSING TUBES  
WITH ALL POLES IN THE "OFF" POSITION.
11. ▲ DENOTES CRITICAL PARAMETER.

<b>B</b>	<b>13130</b>	<b>REMOVE TABLE, REDRAW</b>	<b>5/12/03</b>	<b>AR</b>
<b>A</b>		<b>RELEASED FOR PRODUCTION</b>	<b>12/4/96</b>	<b>MM</b>
<b>REV.</b>	<b>ECN No.</b>	<b>DESCRIPTION</b>	<b>DATE</b>	<b>CHKD</b>

<b>E-SWITCH®</b>				
TITLE				
KAP1108E				
SCALE	2:1	DATE	5/12/03	DR
				AR
		DWG	N411082	REV
				B

THE INFORMATION CONTAINED IN THIS DOCUMENT IS PROPRIETARY TO E-SWITCH AND IS NOT TO BE COPIED OR TRANSFERRED