

DO NOT SCALE

DIMENSIONS IN mm

METRIC

THIRD ANGLE PROJECTION

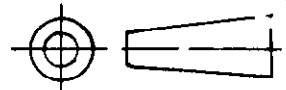

LTR.	REVISION RECORD	DR.	CHK.	DATE
C1	ECO-09-026346	KK	AEG	26NOV09

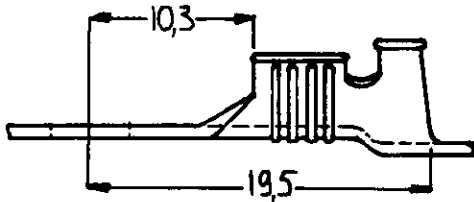
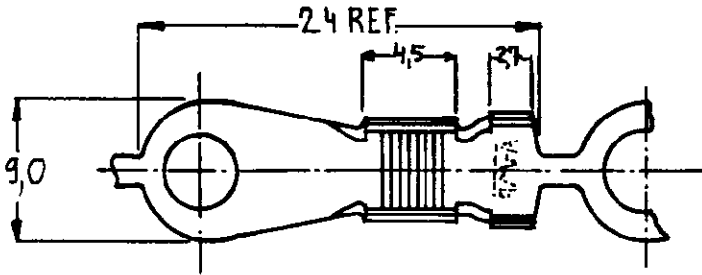

5 OBSOLETE PARTS: OBSOLETE CIS STREAMLINING PER D.RENAUD/D.SINISI

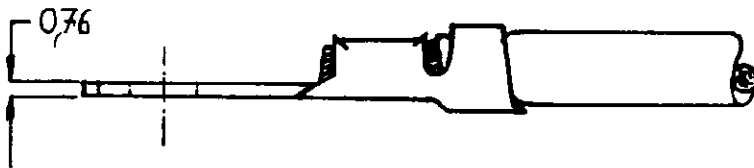
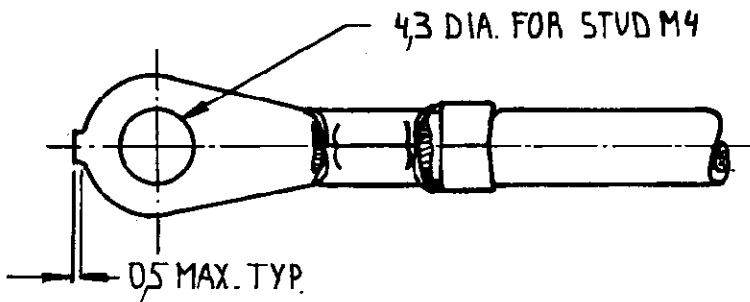

DOC. CENTRE

03 NOV. 1994

NOTES: 1 FOR USE ON STANDARD AND MINIATURE APPLICATORS.

2 FOR USE ON MINIATURE APPLICATORS. (AMP-O-MATOR APPLICATION)

3 REELED WITH PAPER

4 REELED WITH PAPER AND PAPERCOVER

NOTES	FINISH	MATERIAL	PART NUMBER
5	UNPLATED	PHOSPHOR BRONZE	160163-5
OBSOLETE	UNPLATED	BRASS	160163-4
OBSOLETE	UNPLATED	PHOSPHOR BRONZE	160163-3
	TINPLATED	BRASS	160163-2
	UNPLATED	BRASS	160163-1

CUSTOMER DRAWING

AMP

AMP-HOLLAND B.V.
's-Hertogenbosch, The Netherlands

FOR REFERENCE ONLY
WILL NOT BE UPDATED

THIS DRAWING IS UNPUBLISHED -RELEASED FOR PUBLICATION- .19

© COPYRIGHT 19 BY AMP-HOLLAND B.V.
ALL INTERNATIONAL RIGHTS RESERVED.
AMP PRODUCTS MAY BE COVERED BY U.S. AND FOREIGN PATENTS AND/OR PATENTS PENDING.

DR. 21/4-83	WIRE RANGE 3,1 - 5,3 mm ²	NAME RINGTONGUE WITH INSULATION SUPPORT	REV. DATE D M Y	
CHK. 28/4-83	INSUL. RANGE 3,8 - 5,3 DIA.		26	11
APP. 28.4.83	SIZE A4	SHEET [OF]	DRAWING NO C-160163	
				REV. LTR. C1