

ENG110B

DWG. NO. 25M5044

ALL REVISIONS TO THIS DRAWING
MUST BE MADE ON THE CAD SYSTEM

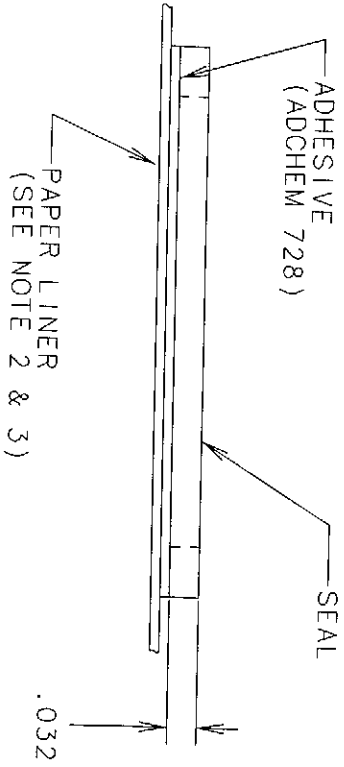
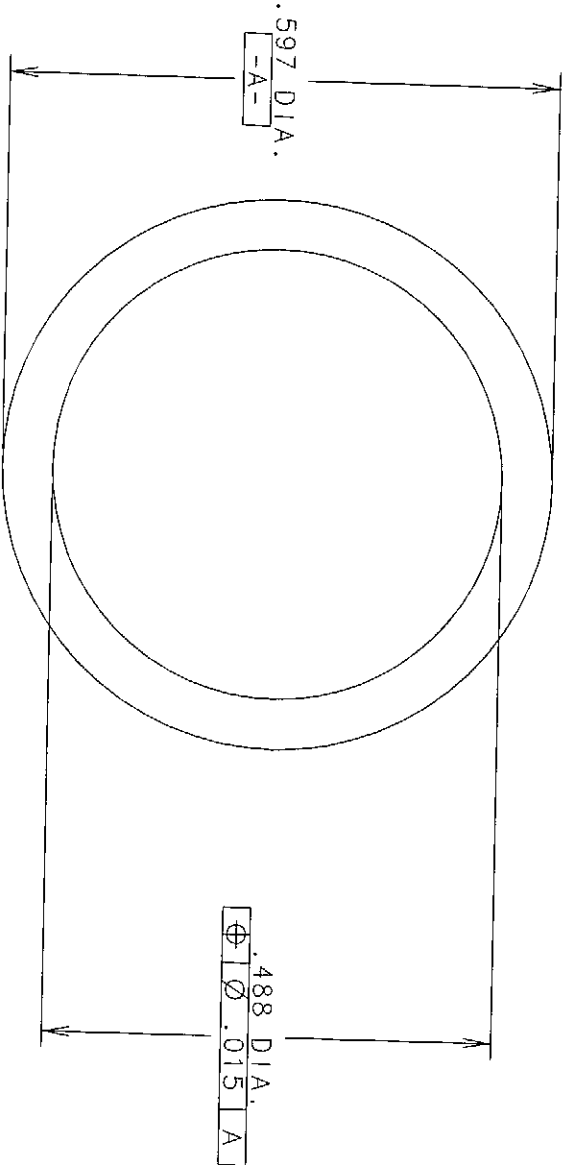

NOTES:

1. SEALS WILL BE RED IN COLOR AND SUPPLIED IN STRIPS.
2. SEALS WILL BE TOTALLY CUT THROUGH WITH I.D.'S INTACT.
3. NICKS ON EITHER EDGE ARE ACCEPTABLE IF DIMENSIONS REMAIN WITHIN PRINT TOLERANCE.
4. SURFACE SCRATCHES ARE ACCEPTABLE IF THEY DO NOT COMPLETELY CROSS BETWEEN THE I.D AND O.D.

ISSUE	APP/DATE	DESCRIPTION
A	KKK	ORIGINAL
		DWS
		EON 514342 5-14-96

REVISIONS



GRAYHILL, INC.
561 HILLGROVE AVE.
LA GRANGE, IL 60525
PHONE (708) 354-1040

UNLESS OTHERWISE SPECIFIED TOLERANCES AND DIMENSIONS ARE IN INCHES
LINEAR ±.005 DIAMETERS ±.015
ANGULAR ± ---
LIMITS APPLY BEFORE FINISHING
DO NOT SCALE THIS PRINT

MFG. INSTR.
Q.C. INSTR.

FINISH	APPROVED DATE
KKK	5-14-96
MATERIAL	CHECKED DATE
DURO SILICONE	CJG 5-14-96
NAME	DRAWN DATE
GASKET	DWS 5-14-96
CAGE NO.	CADAM DRAWING
81073	25M5044, A.01, 1, 1

DWG. NO.	ISSUE
A	A
25M5044	
SCALE 5:1 (R)	SHEET 1 OF 1