



PRODUCT NUMBER
20020414-XXXXXXXXLF

20020414-□ □ □ □ □ 0 □ LF

PITCH
G: 5.00 mm

POLES

2: 2 POLES
3: 3 POLES
:
24: 24 POLES

LF: DENOTED ROHS COMPATIBLE

1 : STANDARD PRODUCT
W/ BOX PACKING

CODE	TYPE
0	TYPE A
1	TYPE B

HOUSING CODE

CODE	COLOR
2	BLACK

NOTES:

- MATERIAL
1-1 HOUSING: THERMOPLASTIC RESIN UL94V-0 RATED.
1-2 TERMINAL: BRASS, TIN PLATED.
- PRODUCT SPECIFICATION REFER TO FCI GS-12-625.
- PRODUCT PACKING SPECIFICATION REFER TO FCI GS-14-1394.
- FCI, SAFETY CERTIFICATE LOGO AND SERIES NAME TO BE SHOWN ON PRODUCT SURFACE.
- THE PRODUCTS WHERE THE PART NUMBER END IN "LF" MEET THE EUROPEAN UNION DIRECTIVE AND OTHER COUNTRY REGULATIONS AS DESCRIBED IN GS-22-008.

mat'l. code				surface ASME Y14.5 ✓ ASME Y14.5		tolerance ASME Y14.5		projection 		product family TERMINAL BLOCK	
ltr				ecn no		dr		date		title	
A				T-012251		LS		071312		TERMINAL BLOCK	
B						LS		071912		PLUGGABLE SOCKET, SIGNAL	
				angles		linear		X.±0.5		MM	
				X'±1'		X.XX±0.1		scale		dwg no	
				dr		LEIF SHEN		032112		sheet 1 of 3 size	
				enr		LEIF SHEN		032112		20020414	
				chr		LEIF SHEN		032112		A4	
				appd		JOSEPH HSIA		032112		type	
										CUSTOMER Drawing	
sheet index		revision sheet		B		B		B			
		1		2		3					



PRODUCT NUMBER	PITCH
20020414-GXXX0XXLF	5.00 mm

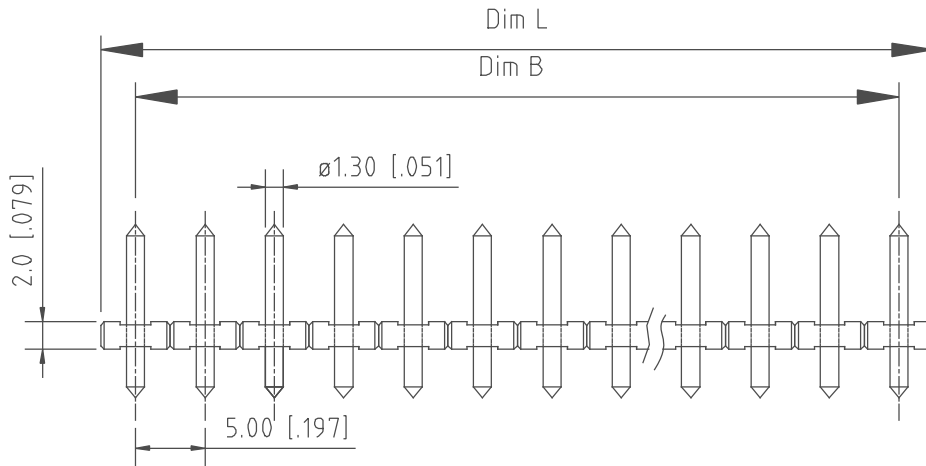

RECOMMEND P.C.B. LAYOUT

PROPERTY TABLE			
CERTIFICATE TYPE	UL	VDE	TUV
PITCH (mm)	5.00	5.00	5.00
VOLTAGE RATING (VAC)	300	300	300
CURRENT RATING (A)	15	12	15
WITHSTANDING VOLTAGE (kV)	1.6	2.5	2.5
OPERATING TEMP. (°C)	-40~+115	-40~+115	-40~+115
SOLDERING TEMP. (°C)	250±10 (5 sec.)	250±10 (5 sec.)	250±10 (5 sec.)
POLES AVAILABLE	2~24	2~24	2~24
SAFETY CERTIFICATE			

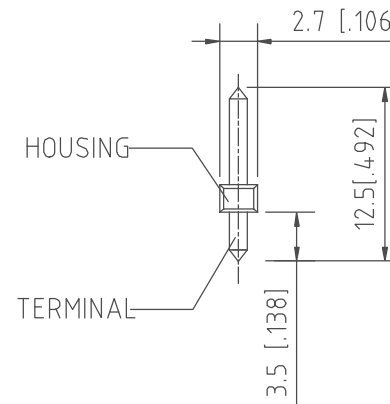

N = Number of poles
Dim L = N x 5.0 [.197]
Dim B = (N-1) x 5.0 [.197]

	Tolerance
2-5p	±0.10 [.004]
6-9p	±0.15 [.006]
10-13p	±0.20 [.008]
14-17p	±0.25 [.010]
18-21p	±0.30 [.012]
22-24p	±0.40 [.016]

mat'l. code		surface ASME Y14.5	tolerance ASME Y14.5	projection 	product family TERMINAL BLOCK		
ltr	ecn no	dr	date	title			
B				TERMINAL BLOCK PLUGGABLE SOCKET, SIGNAL			
angles		linear	X.±0.5	MM	scale		
X'±1'		linear	X.X±0.3				
		linear	X.XX±0.1				
dr	LEIF SHEN	032112			dwg no	sheet 2 of	size
enr	LEIF SHEN	032112			20020414		A4
chr	LEIF SHEN	032112			type	CUSTOMER Drawing	
appd	JOSEPH HSIA	032112					
sheet index	revision sheet						

PRODUCT NUMBER	PITCH
20020414-GXXX1XXLF	5.00 mm

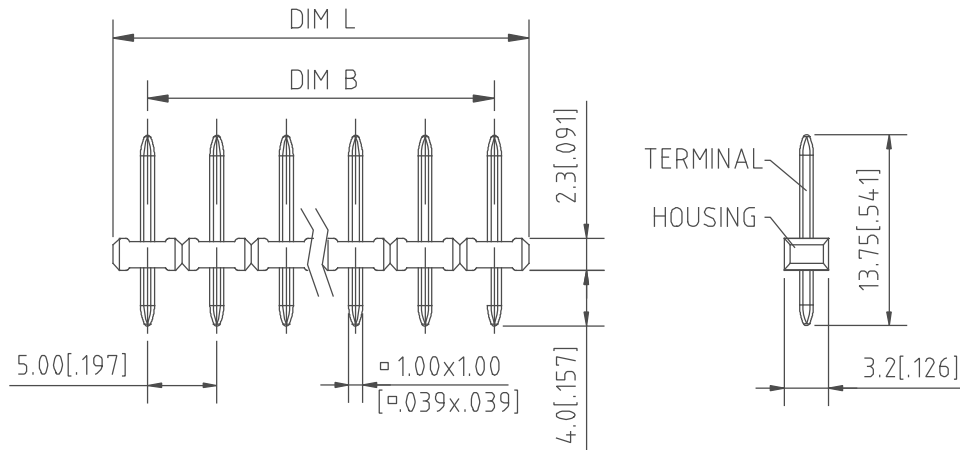

PROPERTY TABLE	
CERTIFICATE TYPE	UL
PITCH (mm)	5.00
VOLTAGE RATING (VAC)	300
CURRENT RATING (A)	15
WITHSTANDING VOLTAGE (kV)	1.6
OPERATING TEMP. (°C)	-40~+115
SOLDERING TEMP. (°C)	250±10 (5 sec.)
POLES AVAILABLE	2~24
SAFETY CERTIFICATE	

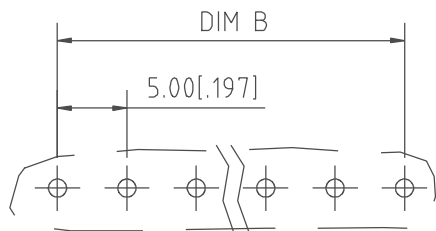

RECOMMENDED P.C.B. LAYOUT

N = Number of poles
 Dim L = N x 5.0 [.197]
 Dim B = (N - 1) x 5.0 [.197]

	Tolerance
2-5p	±0.10 [.004]
6-10p	±0.15 [.006]
11-15p	±0.20 [.008]
16-20p	±0.25 [.010]
21-24p	±0.30 [.012]

mat'l. code		surface ASME Y14.5 ✓	tolerance ASME Y14.5	projection	product family TERMINAL BLOCK
ltr	ecn no	dr	date	tolerances unless otherwise specified	title
B				angles X.±0.5	TERMINAL BLOCK
				linear X.X±0.3	PLUGGABLE SOCKET, SIGNAL
				X'±1' X.XX±0.1	scale
		dr	LEIF SHEN 032112		dwg no
		enr	LEIF SHEN 032112		sheet 3 of
		chr	LEIF SHEN 032112		size
		appd	JOSEPH HSIA 032112		20020414 A4
sheet index	revision sheet				type CUSTOMER Drawing