

LOC		DIST		REVISIONS			
TR	BY	DATE	DESCRIPTION	DATE	OWN	APVD	
C			REVISED PER EC 0513-0122-02	22APR02	DD	CC	

- ① MATERIAL: HOUSING - NYLON, UL94V-0 (COLOR - BLACK).  
CONTACTS - 0.25 THK COPPER ALLOY.
- ② CONTACT FINISH: 0.003 MIN THK TIN-LEAD OVER 0.00127 MIN THK NICKEL, ALL OVER.
- ③ CONTACT OMITTED FROM POSITION SHOWN.
- 4. SOLDER TAIL MEETS AMP SOLDERABILITY SPECIFICATION 109-11-2.
- 5. MATES WITH SIMILARLY PLATED AMP-DUAC™ POWER CONNECTOR RECEPTACLE HOUSINGS/SOCKET CONTACTS.

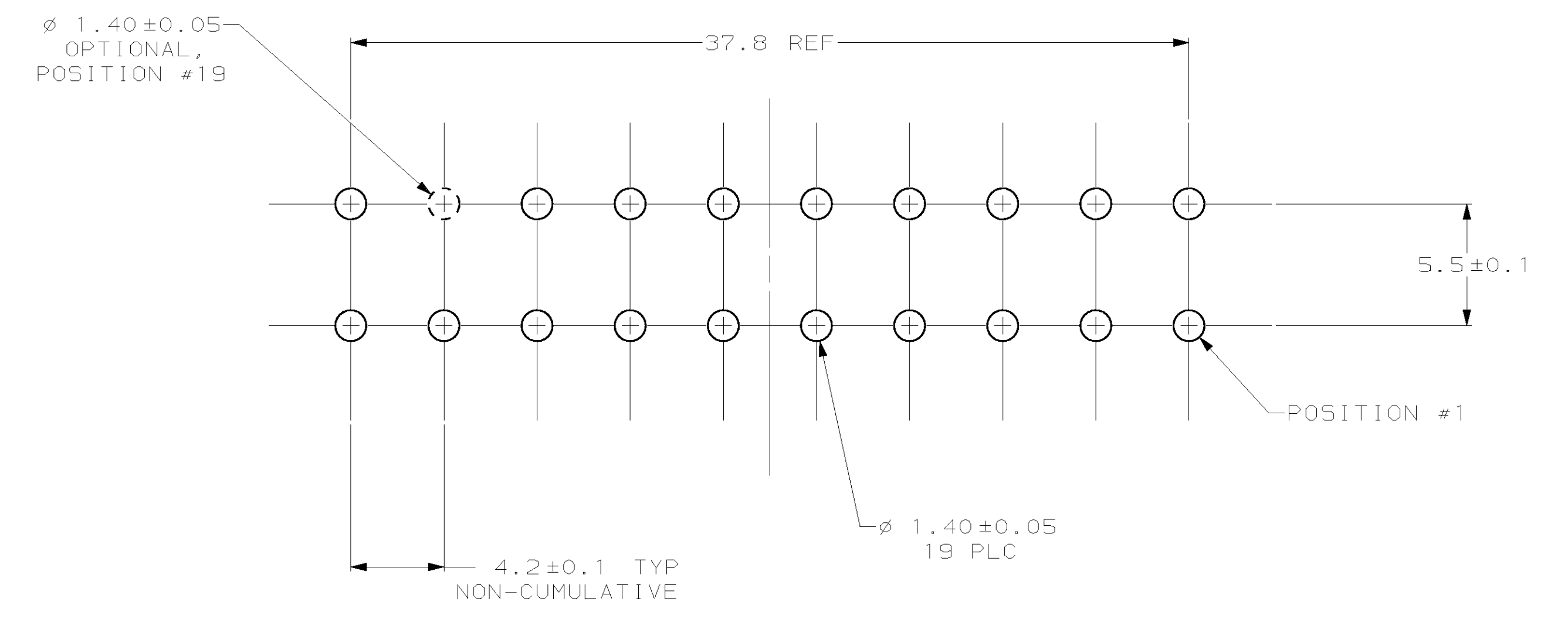

RECOMMENDED MOUNTING HOLE PATTERN FOR 1.78 MAX THICK P.C. BOARD COMPONENT SIDE SHOWN

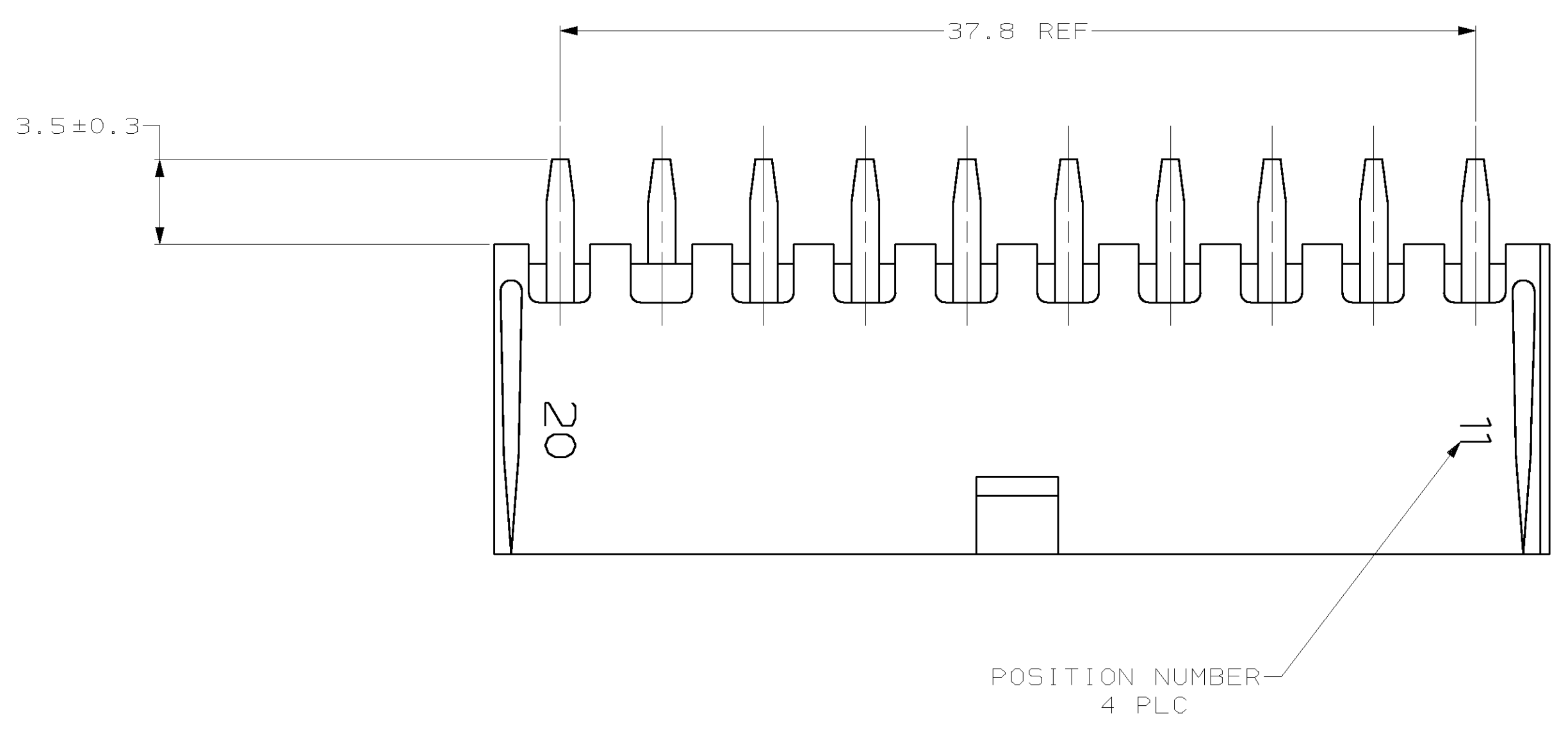
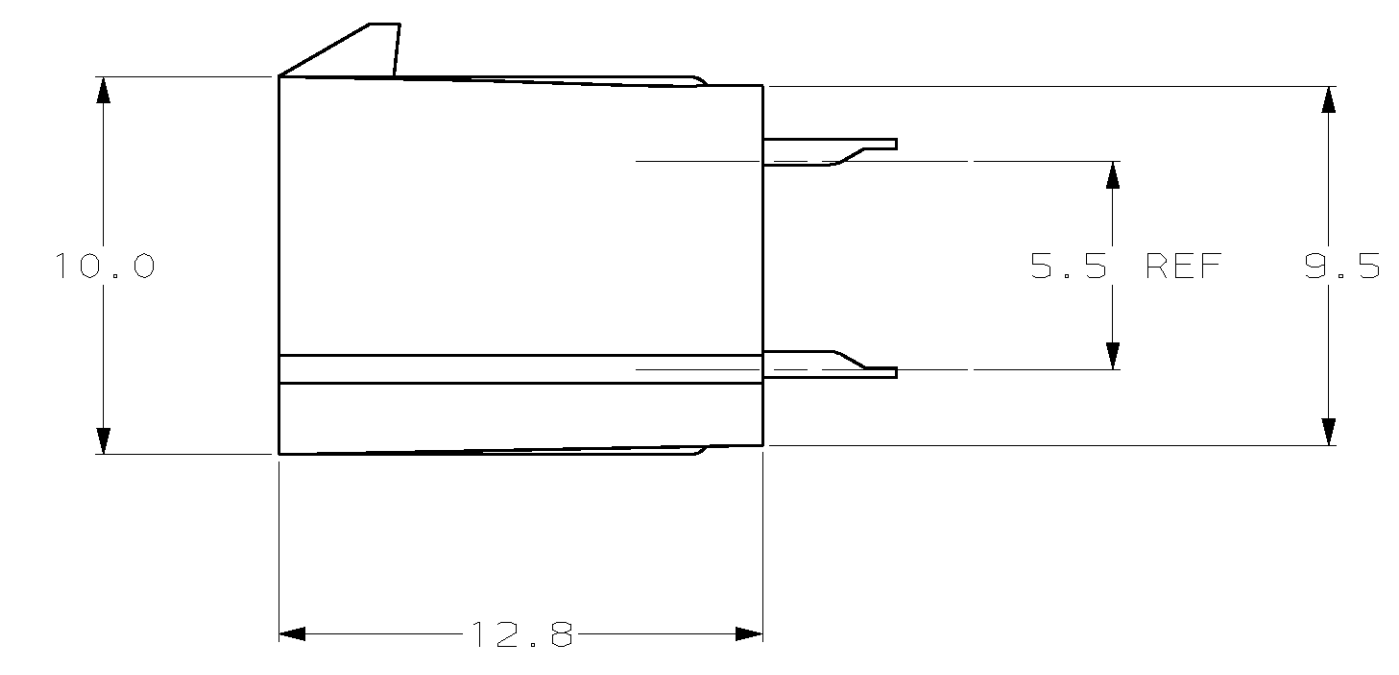
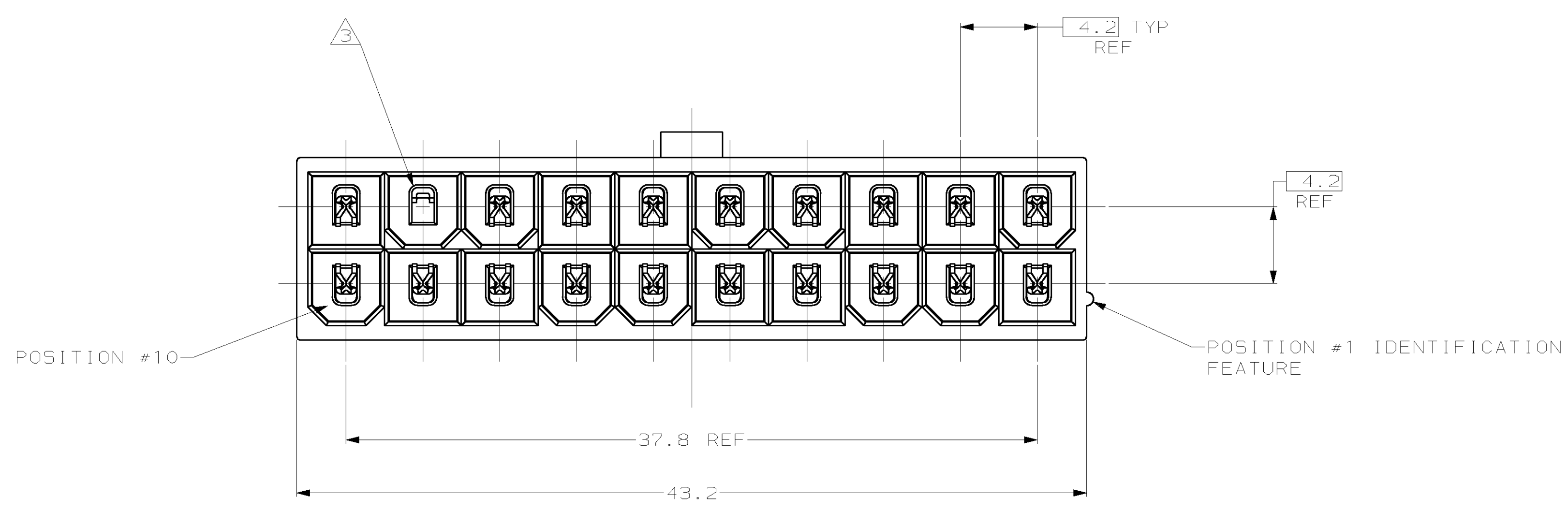

①	②	①	①	794430-1												
MATERIAL	FINISH	MATERIAL	COLOR	PART NUMBER												
CONTACT		HOUSING														
THIS DRAWING IS A CONTROLLED DOCUMENT.		DWN R. VESTAL 3-18-98	AMP Incorporated Harrisburg, PA 17105-3608													
DIMENSIONS: mm		CHK R. SWING 3-18-98	APVD C. CASH 3-18-98													
TOLERANCES UNLESS OTHERWISE SPECIFIED:		NAME ASSEMBLY, HEADER, HI-TEMP, VERTICAL, 20 POSITION, CIRCUIT 19 OMITTED, AMP-DUAC™ POWER CONNECTOR														
<table border="1"> <tr> <td>0 PLC</td> <td>±-</td> </tr> <tr> <td>1 PLC</td> <td>±0.2</td> </tr> <tr> <td>2 PLC</td> <td>±0.13</td> </tr> <tr> <td>3 PLC</td> <td>±-</td> </tr> <tr> <td>4 PLC</td> <td>±-</td> </tr> <tr> <td>ANGLES</td> <td>±-</td> </tr> </table>		0 PLC	±-	1 PLC	±0.2	2 PLC	±0.13	3 PLC	±-	4 PLC	±-	ANGLES	±-	PRODUCT SPEC 108-1699		
0 PLC	±-															
1 PLC	±0.2															
2 PLC	±0.13															
3 PLC	±-															
4 PLC	±-															
ANGLES	±-															
MATERIAL SEE TABLE		APPLICATION SPEC -														
FINISH SEE TABLE		WEIGHT -														
		SIZE A1														
		SCALE 5:1														
		SHEET 1 of 1														
		REV C														
		CUSTOMER DRAWING														
		DRAWING NO 00779														
		DRAWING NO 794430														
		RESTRICTED TO -														